

NOTES:

1. Set of 4 qty.
2. Hardware Included.
3. Weight Capacity 5 lbs on drywall with plastic anchor. Weight capacity 12 lbs when mounted into stud or using HD-Anchor (recommended for bottom barrels since they will be bearing most of the weight).
4. Recommended spacing is 12 in. on center.
5. Recommended to install into studs.
6. Use 1/4" thick mirror only.

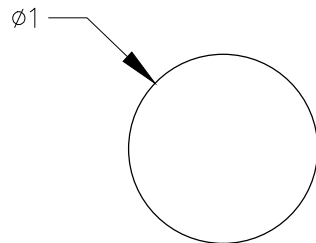

FRONT VIEW

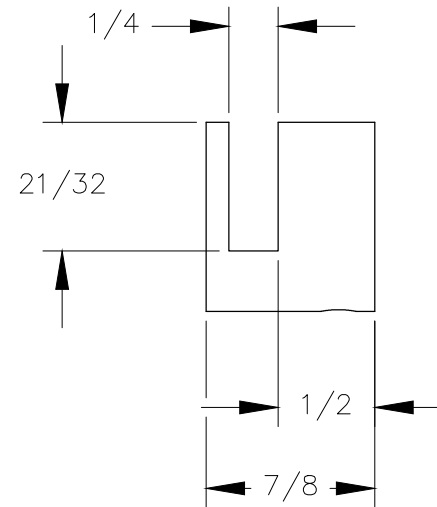

RIGHT VIEW