

NOTE:

- USB port is for charging use ONLY.
- Wireless output is 10W Max.
- Mobile device must be equipped with a wireless charging receiver (Wireless charging accessories not included.) Check mobile manufacturer for compatibility.
- Cord length is 4 ft.
- Power adapter dimension is 1-27/32" X 1-1/2" X 29/32".

2

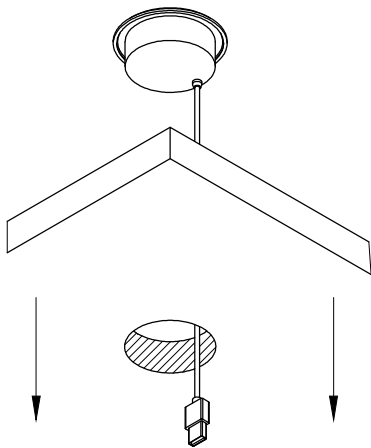

Install the unit into the cut out and be sure it is fully level on the surface. Use of adhesive is recommended for a more secure fitting (Not included).

4

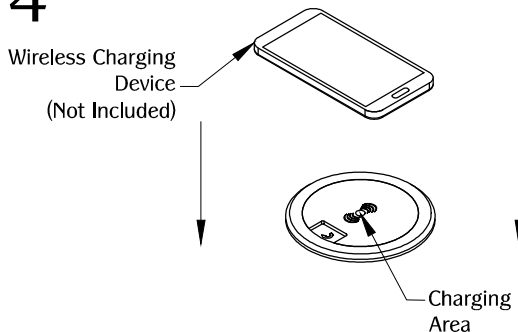

Position the mobile device on the center of the charging area. The charging icon will activate on the device's screen when properly aligned at the center of the charging area.

1

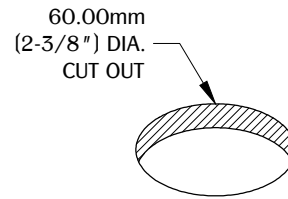

Determine the position and location of the unit on the work surface. Cut the hole at 2-3/8" DIA.

3

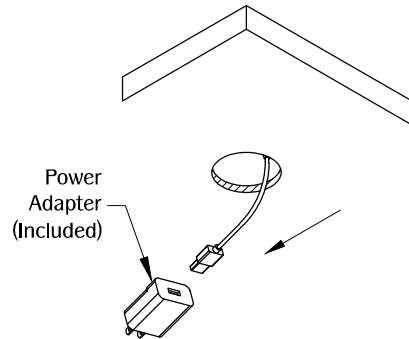

Plug in the USB cord from the unit to the power adapter. Plug the power adapter into a nearby outlet (outlet should be close enough to where power cord is not taut or strained) and unit is ready for use.

5

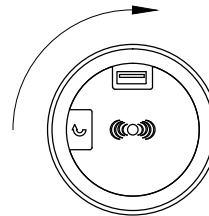

For tethered USB charging access(non-wireless) rotate the cover until you see USB port.

TABLE OF CONTENTS:



.....1X WCS8



.....1X Power Adapter