

NOTE:

- Weight capacity is 25 lbs.
- Shelf projection is 12" MAX.
- Bracket spacing is 24" MAX.
- Shelf thickness is 10.00mm (13/32") MIN. to 48.00mm (1-7/8") MAX.

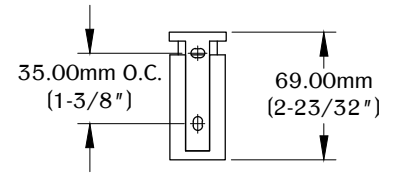

REAR VIEW

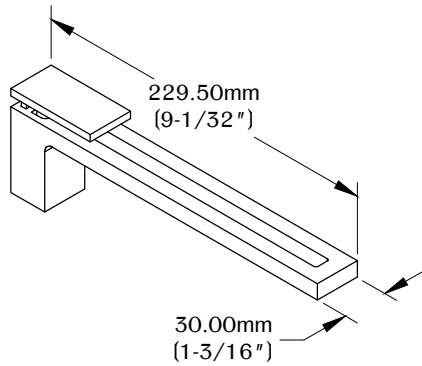
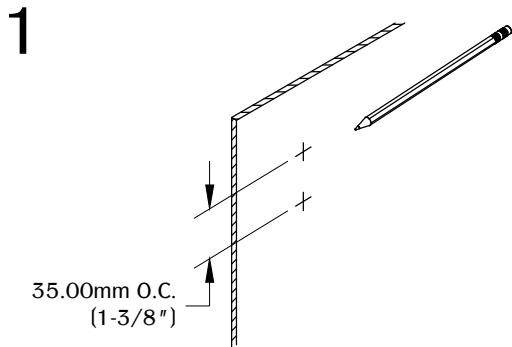

Determine the position and location of the part on the work surface. Mark the mounting positions for the mounting hardware.

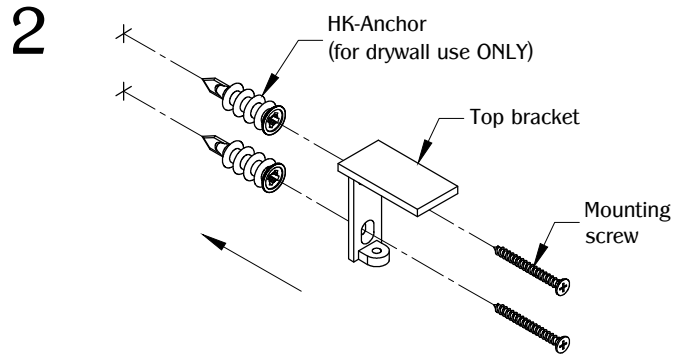

Install the top bracket of the SH48B. Make sure the part is leveled and aligned straight. Then, install the part with the mounting hardware.

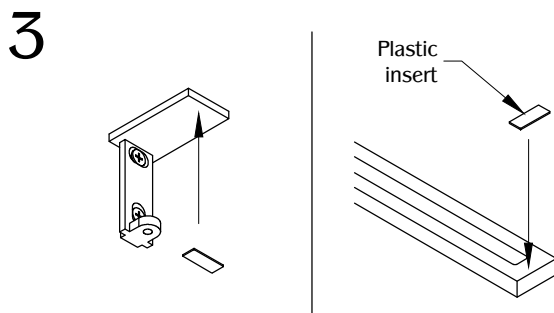

Stick the (2) soft plastic inserts on the top front of the lower bracket and under the top front of the top bracket. (Note: Additional soft plastic inserts are provided but not required.)

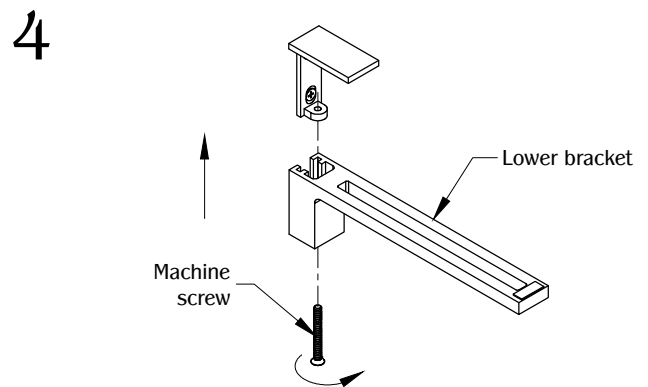

Align the lower bracket to the top bracket. Secure the part with the machine screw.

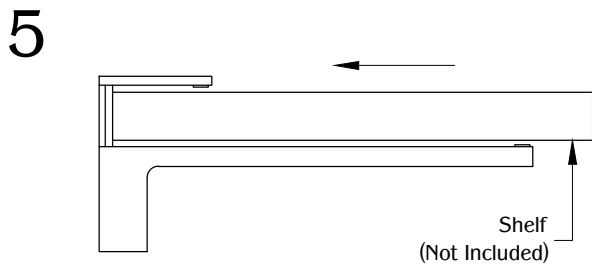

Install the shelf to the SH48B by tightening the machine screw until the shelf is secure. (Note: DO NOT overtighten the machine screw.)

TABLE OF CONTENTS:

	1X SH48B
	2X HK-Anchor
	4X Soft plastic insert
	1X Machine screw
	2X 1-7/8" No. 10 Wood screws
	2X Plastic anchor (Not Required for Install)