

USER MANUAL

MODELS:

PCS88-90 (Black)

PCS88-94 (Silver)

Pop-up Table Connection Bus

Step 1: Check what's in the box

- ✓ PCS88-90 or PCS88-94
- ✓ 1 cut out template
- ✓ 1 power cord
- ✓ 2 table clamps
- ✓ 1 quick start guide

Save the original box and packaging materials in case you need to return your product for service.

Step 2: Prepare the table for mounting

Cut out an opening in the table using the cut out template.

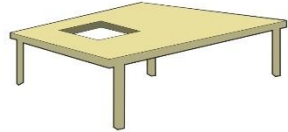

Step 3: Install the PCS88-90 / PCS88-94

Connect the power cable.

Insert the unit through the table opening.

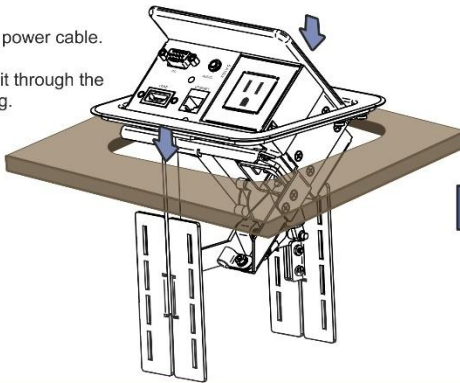

Mount the Brackets, secure the unit to the table and connect the cables.

Contents

1	Introduction	1
2	Getting Started	2
2.1	Achieving the Best Performance	2
2.2	Recycling Products	2
3	Overview	3
4	Defining the PCS88-90 / PCS88-94	4
4.1	The PCS88-90 / PCS88-94 Connecting Surface	5
5	Installing the PCS88-90 / PCS88-94	6
5.1	Cutting an Opening	6
5.2	Inserting the PCS88-90 / PCS88-94 through the Cut-Out Opening	8
5.3	Connecting the Cables	8
6	Technical Specifications	9

Figures

Figure 1:	PCS88-90 / PCS88-94 Pop-up Table Connection Bus	3
Figure 2:	Defining the Parts of the PCS88-90 / PCS88-94 Pop-up Table Connection Bus	4
Figure 3:	PCS88-90 / PCS88-94 Connecting Surface	5
Figure 4:	Cut out Dimensions (not to scale)	7

1 Introduction

Thank you for purchasing the **PCS88-90 / PCS88-94** Pop-up Table Connection Bus, with power, HDMI, VGA, 3.5mm audio, and R-J45 inputs, which is ideal for the following typical applications:

- Boardrooms
- Conference rooms
- Training rooms

Your Pop-up Table connection Bus with power, HDMI, VGA, 3.5mm audio, and RJ-45 inputs is available in two models: black sandblast finish (model **PCS88-90**) and silver sandblast finish (model **PCS88-94**).

2 Getting Started

We recommend that you:

- Unpack the equipment carefully and save the original box and packaging materials for possible future shipment
- Review the contents of this user manual

2.1 Achieving the Best Performance

To achieve the best performance:

- Use only good quality connection cables (we recommend high-performance, high-resolution cables) to avoid interference, deterioration in signal quality due to poor matching, and elevated noise levels (often associated with low quality cables)
- Do not secure the cables in tight bundles or roll the slack into tight coils
- Avoid interference from neighboring electrical appliances that may adversely influence signal quality
- Position your **PCS88-90 / PCS88-94** away from moisture, excessive sunlight and dust



This equipment is to be used only inside a building. It may only be connected to other equipment that is installed inside a building.

Do not place heavy objects on top of the **PCS88-90 / PCS88-94**.

2.2 Recycling Products

The Waste Electrical and Electronic Equipment (WEEE) Directive 2002/96/EC aims to reduce the amount of WEEE sent for disposal to landfill or incineration by requiring it to be collected and recycled. To comply with the WEEE Directive, we have made arrangements with the European Advanced Recycling Network (EARN) and will cover any costs of treatment, recycling and recovery of our branded waste equipment on arrival at the EARN facility.

3 Overview

The **PCS88-90 / PCS88-94** is a furniture-mounted pop-up connection bus that is easily installed into a table or podium top. The **PCS88-90 / PCS88-94** interface enables you to connect any equipment to systems installed in a room via the following pass-through connectors:

- 1 PC on a 15-pin HD connector
- 1 HDMI connector
- 1 stereo audio on a 3.5mm connector
- 1 Ethernet RJ-45 connector

The **PCS88-90 / PCS88-94** supports HDMI with Deep Color, x.v.Color™, Lip Sync, HDMI Uncompressed Audio Channels, Dolby TrueHD, DTS-HD, and CEC.

The **PCS88-90** surface has a black anodized finish. The **PCS88-94** surface has a brushed anodized finish.

When not in use, you can lower the **PCS88-90 / PCS88-94** flush into the table. The example in [Figure 1](#) shows the **PCS88-90 / PCS88-94** in a table or podium top with a universal power socket.

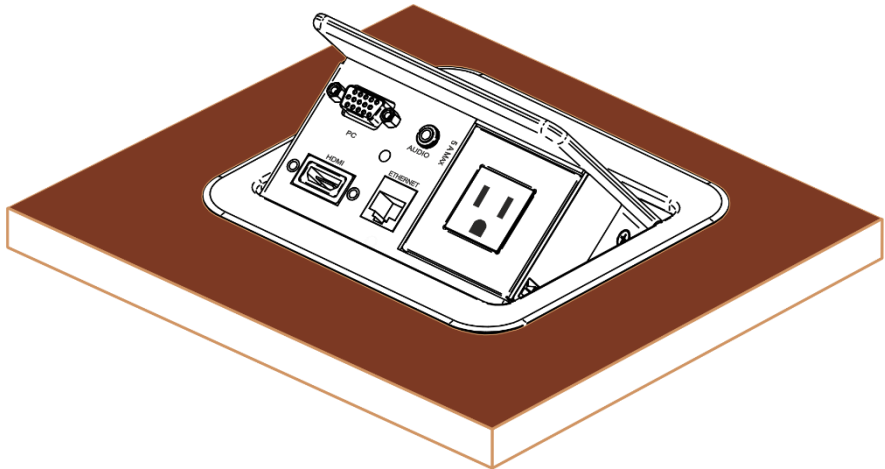

Figure 1: PCS88-90 / PCS88-94 Pop-up Table Connection Bus

4 Defining the PCS88-90 / PCS88-94

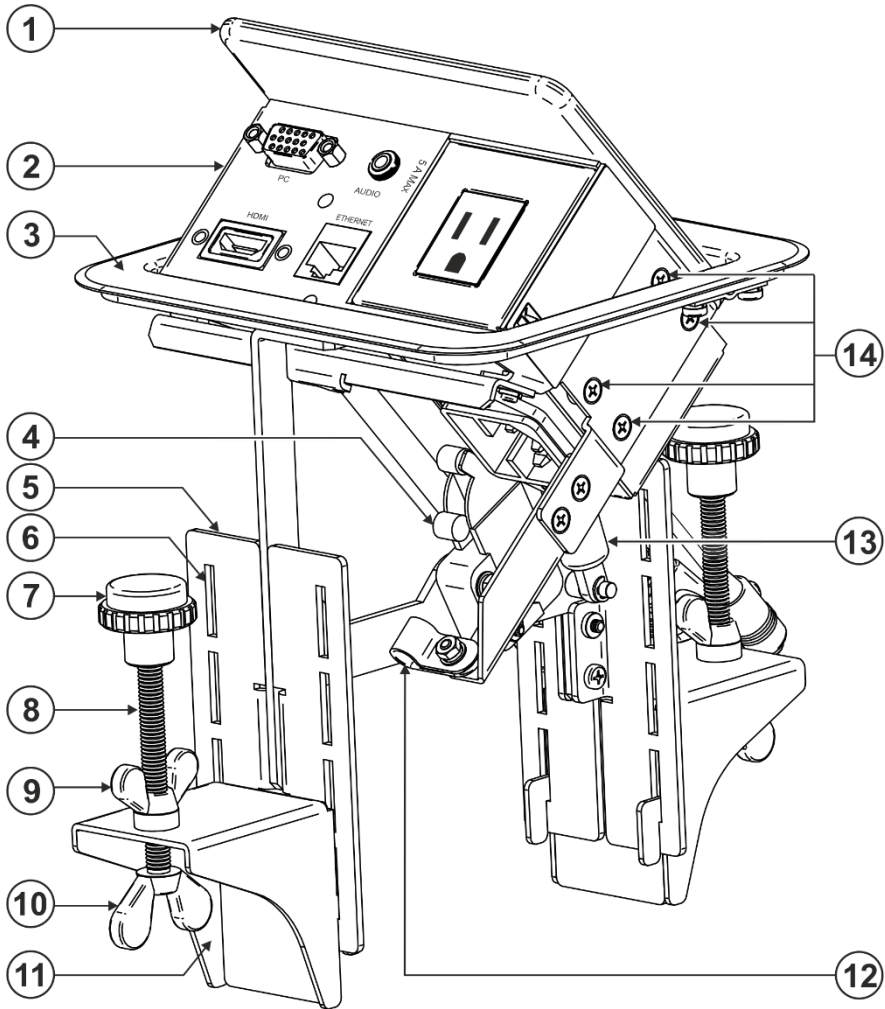

Figure 2: Defining the Parts of the PCS88-90 / PCS88-94 Pop-up Table Connection Bus

#	Feature	Function
1	Black anodized or brushed anodized aluminum semi-automatic lid	Covers the connecting surface, leaving the table surface neat and tidy
2	Connecting Surface	See Section 4.1
3	Outer Rim	Fits over the table surface

#	Feature	Function
4	Mini Latch	Enables the closing and opening of the lid by slightly pressing it
5	Mounting Clamp Plates	For holding the clamps
6	Mounting Clamp Slits (four sets on each side)	Insert the mounting clamps to the slits when installing the PCS88-90 / PCS88-94
7	Rubber Protectors (2)	To ensure soft tightening to the table underside
8	Mounting Screws (2)	For securing the PCS88-90 / PCS88-94 to the table
9	Locking Butterfly Nuts (2)	Tighten to lock the mounting butterfly screw
10	Mounting Butterfly Nuts (2)	Tighten to secure the unit to the table surface
11	Mounting Clamps (2 units)	Place in the clamp slits after inserting the enclosure into the table – for securing the unit to the table surface
12	Power Connector Lock	Secures the power cable so it does not accidentally disconnect when opening the lid
13	Pneumatic Piston	Enables automatic lifting and smooth closing of the lid
14	Power Socket Opening Screw Holes (4)	For installing/replacing the power socket

4.1 The PCS88-90 / PCS88-94 Connecting Surface

[Figure 3](#) defines the connecting surface:

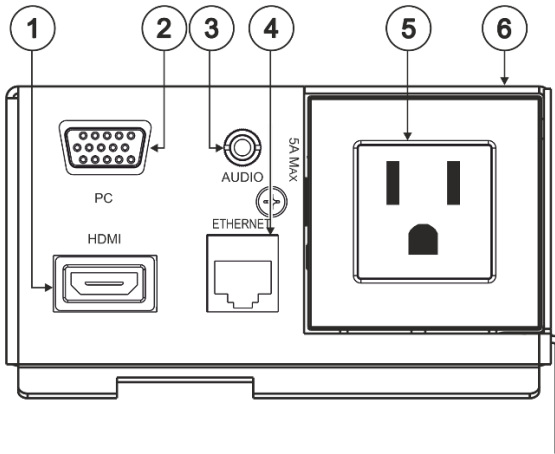

Figure 3: PCS88-90 / PCS88-94 Connecting Surface

#	Feature	Function
1	HDMI Connector	Connect to an HDMI source
2	PC 15-pin HD Connector	Connect to a computer graphics source
3	AUDIO 3.5mm Mini Jack	Connects to an unbalanced stereo audio source
4	ETHERNET Connector	Connects to the PC or other Controller through computer networking
5	Power Socket	AC connector, enabling power supply to the unit
6	Connecting Surface	Pops up when gently pressing the lid

5 Installing the PCS88-90 / PCS88-94

To install the **PCS88-90 / PCS88-94** perform the following steps:

1. Cut an opening in the table (see [Section 5.1](#)).
2. Insert the **PCS88-90 / PCS88-94** through the cut-out opening (see [Section 5.2](#)).
3. Connect the cables (see [Section 5.3](#)).

5.1 Cutting an Opening

1. Use the template and trace the inside edge cut out on the work surface.



The thickness of the table should be 1" min. to 3" max.

2. Lay the template flat on the surface and trace the **INSIDE** edge on the work surface.
3. Remove template and use the trace of the **INSIDE** edge of the template on the surface to cut with a sabre or keyhole saw according to the dimensions shown in **Figure 4** (not to scale).

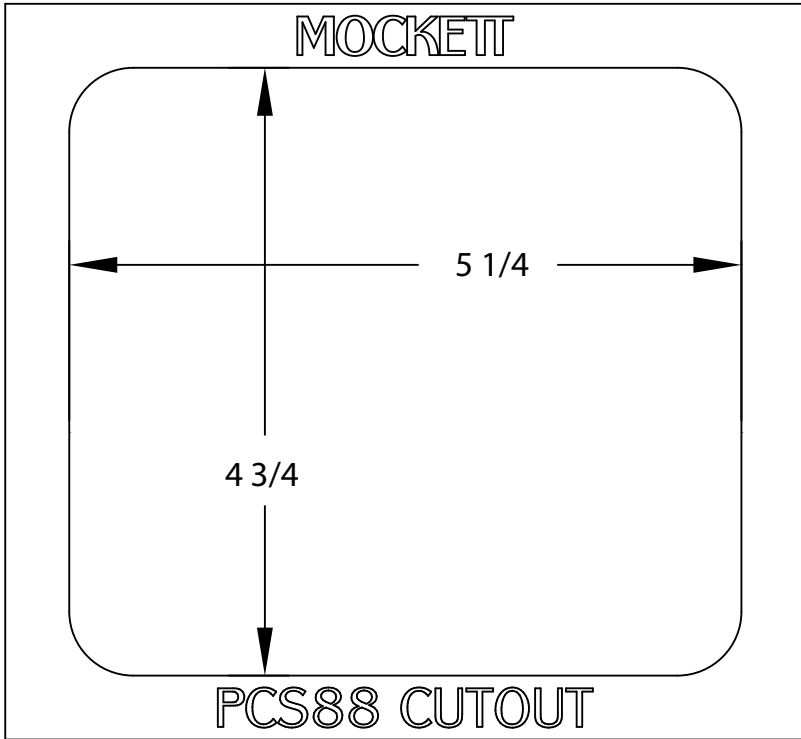

Figure 4: Cut out Dimensions (not to scale)

5.2 Inserting the PCS88-90 / PCS88-94 through the Cut-Out Opening

To install the **PCS88-90 / PCS88-94**, do the following:

1. Unscrew the power connector lock.
2. Connect the IEC power cord to the IEC socket.
3. Insert the power cord into the power connector lock and tighten the screw (see [Figure 2](#), item 12) to secure the power cable.
4. Carefully insert the unit into the prepared opening.
5. Take the support clamps under the table and place them into the support clamp late slits at the desired height (on both the front and rear sides of the unit).
6. Make sure that the upper outer rim is situated parallel to the edge of the table.
7. Insert the mounting screws through the holes in the mounting clamps. Tighten the mounting butterfly nuts to secure the unit to the table surface and then lock with the mounting butterfly screw.

5.3 Connecting the Cables

1. Connect the appropriate cables from underneath.
2. Secure the cables.
Do not keep the cord too tight or too loose.

Once you have connected the unit to the mains power and connected the proper cables, you may use the unit.

6 Technical Specifications

PORTS:	1 HDMI connector, 1 Ethernet RJ-45 connector, 1 15-pin HD connector, 1 3.5mm mini jack
POWER SOURCE (AC power limits):	100-240V AC, 50/60Hz, 5A Maximum 5A per power outlet
FUSE RATING:	T 6.3A 250V
OPERATING TEMPERATURE RANGE:	+5 to +45 Deg. Centigrade
OPERATING HUMIDITY RANGE:	10 to 90% RHL, non-condensing
STORAGE TEMPERATURE RANGE:	-20 to +70Deg. C.
STORAGE HUMIDITY RANGE:	5 to 95% RHL, non-condensing
DIMENSIONS:	Including the outer rim: 14.5cm x 13.2cm x 17.3cm (5.71" x 5.2" x 6.81") W, D, H Without the outer rim: 13.3cm x 12.0cm x 17.3cm (5.24" x 4.72" x 6.81") W, D, H
WEIGHT:	0.85kg (1.87lbs) approx. 1.2kg (2.65lbs) approx. with mounting brackets 1.4 kg (3.1lbs) approx. packed product
INCLUDED ACCESSORIES:	Template for hole cut included, US AC power cord 6 ft.

This page is intentionally left blank



The voltage rating on the mains output receptacle is in accordance with the country's mains voltage to which the device is connected. Do not connect devices to this machine that do not operate in compliance with the country's mains voltage.

CE



SAFETY WARNING

Disconnect the unit from the power supply before opening and servicing