

PART #

PCS78

310.318.2491 • 800.523.1269 • www.mockett.com

**Caution:**

- To reduce the risk of electric shock use only indoors.
- Risk of electric shock. Do not plug into another relocatable power tap.

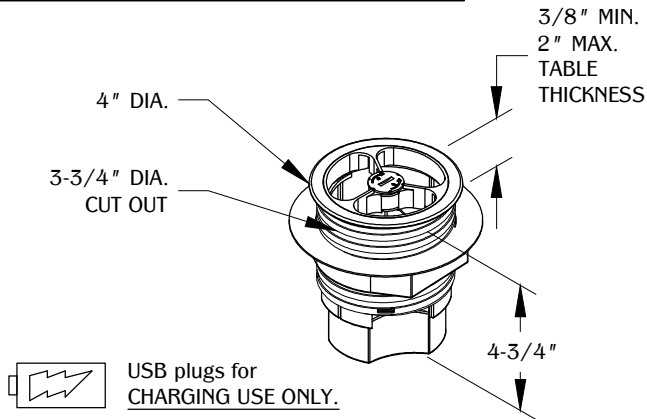

USB plugs for CHARGING USE ONLY.

PCS78

PCS78/USB

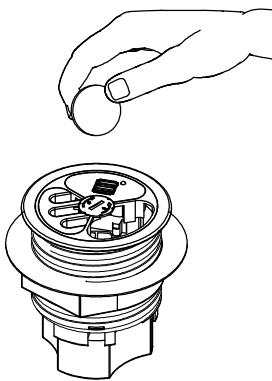
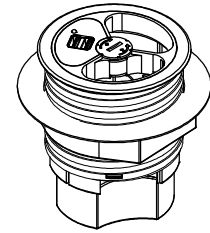
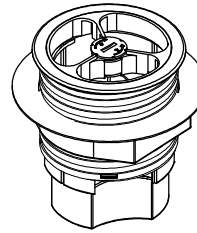

**STEP 1**  
Use a coin to loosen coin cap. Rotate the coin in a counter-clockwise direction until the center cap disengages.

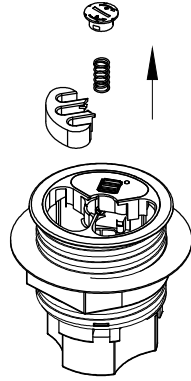

**STEP 2**  
Remove the spring and center cap to free the interchangeable inserts. Remove the desired insert.

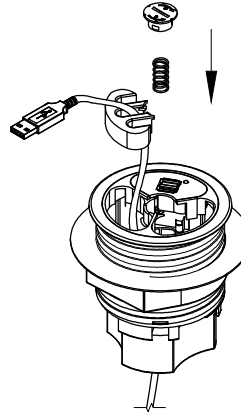

**STEP 3**  
Feed cabling through the unit from below. Insert cabling into any of the open slots on the unit, or if using keystone inserts snap them into the holes, then insert back in the unit.

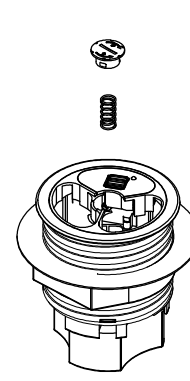

**STEP 4**  
Insert spring and replace the center cap fastening it again in a clockwise direction with a coin.

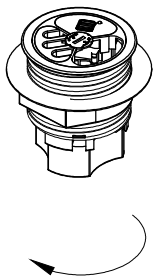

**STEP 5**  
Remove the locking ring by twisting it off in a counter-clockwise direction (when viewed from above). Attach power cord to underside of unit. Do not connect to power until after unit is secured to the table (step 3).

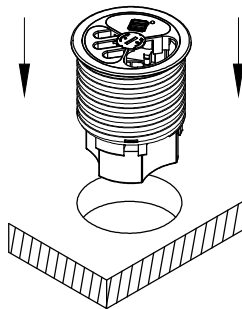

**STEP 6**  
From the top, lead the power cord into the hole, place the unit into the pre-cut mounting hole and position the unit in the preferred orientation.

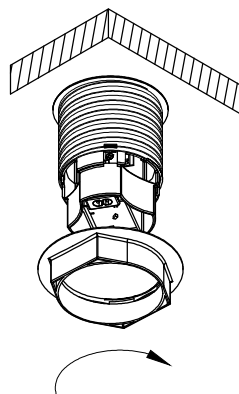

**STEP 7**  
With unit set in the mounting hole, tighten the locking ring by twisting in a clockwise direction until unit is securely fastened. Keep unit in desired position while tightening.

**TABLE OF CONTENTS:**

	.....	1x PCS78
	.....	1x LOCK RING
	.....	* KEYSTONE ADAPTER
	.....	* CABLE HOLDER
	...	1x POWER CORD (FOR PCS78B/USB)

(\* QUANTITY DEPENDS ON VERSION)