

1

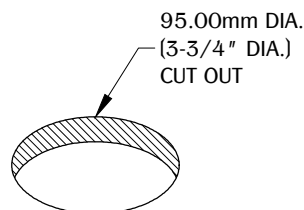

Note:
Minimum clearance required
under the work surface is 18".

Make a cutout in the desired location on your work surface. Allow enough clearance for unit operation. DO NOT place unit where the cable is strained or trapped.

3

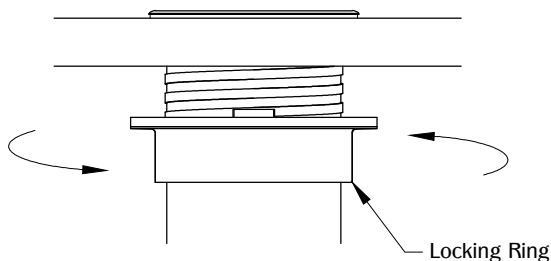

Screw threaded lock ring onto mounting collar by turning clockwise. Locking ring should rotate smoothly once properly engaged. If not, the locking ring may be cross-threaded - undo and try again.

2

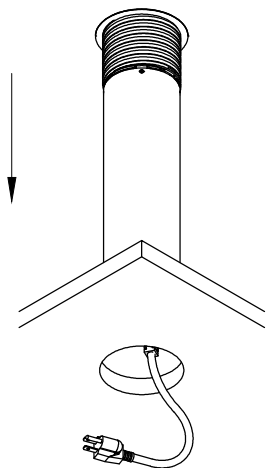

Guide the cord through the cut out. Install the unit into the cutout, make sure it is fully level on the surface, and oriented to the appropriate side.

4

Connect the unit into a nearby outlet.

MAINTENANCE AND CARE:

1. Ensure unit is disconnected prior to cleaning.
2. Clean the unit with a damp cloth and dry immediately.
3. Do not use harsh chemical solvents.

⚠ WARNING ⚠

- USB ports are for charging use ONLY.
- For indoor use only.
- If any malfunction occurs, do not attempt to repair.
- Do not insert foreign objects into power outlets.
- For counter top mounting.
- Risk of electric shock. (Do not connect to another relocatable power tap.)

TABLE OF CONTENTS:



.....1 X PCS64/2/USB

.....1 X Locking Ring