

Toggle Bolt Wings & Anchors

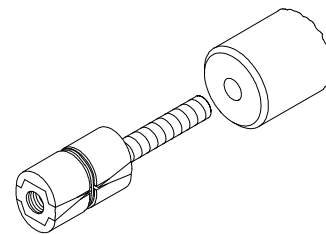
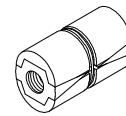
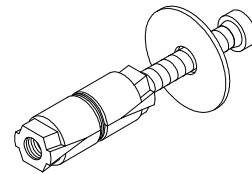
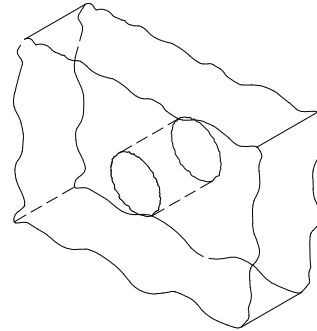
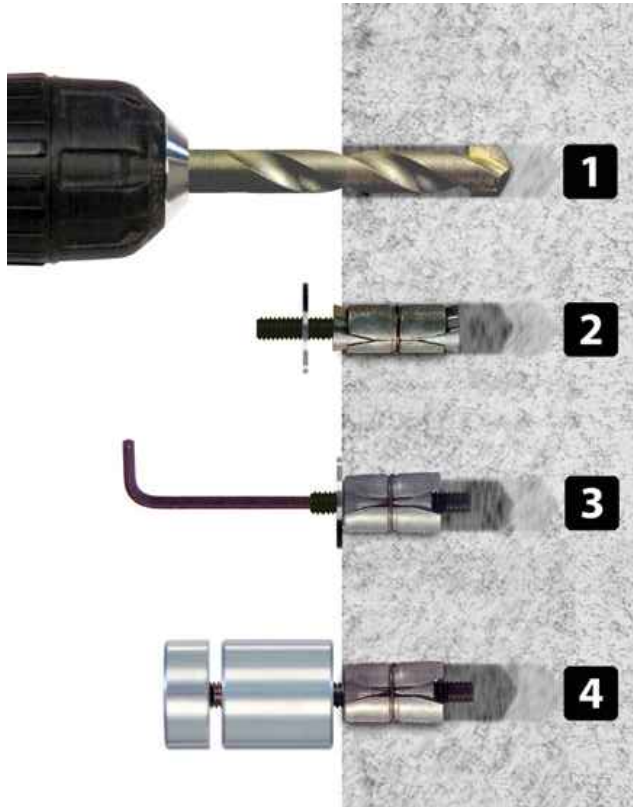

Step 1: Drill a 5/8" diameter by 1-1/2" deep hole in to the mounting surface.

Step 2: Insert the MPB-HD-CON anchor completely in to the hole. (Note: Insert threaded side first.) It should be inserted far enough that the wedge will be slightly below the cement surface when the anchor is tightened.

Step 3: Secure the anchor by using a 5/16" -18 thread X 2" set screw and washer or the 5/16" -18 thread X 2" Low Head Socket Cap Screw and washer with 4mm hex key to set the anchor in the hole. (Note: Hex key NOT INCLUDED.) Tighten until a snap sound.

Step 4: Remove the set screw or Low head and Flat Washer and install appropriate MPB part for your application.

TABLE OF CONTENTS:

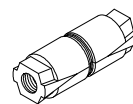

.....1 X MPB-HD-CON ANCHOR

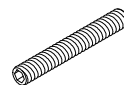

.....1 X 2" SET SCREW

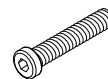

.....1 X 5/16" -18 THREAD LOW HEAD SOCKET CAP SCREW



.....1 X 1-1/4" DIA. WASHER