

# MOCKETT

DOUG MOCKETT & COMPANY, INC.

Part # **FSA1/4H**

310.318.2491 • 800.523.1269 • www.mockett.com

## Instructions

### Flat Screen Arm Bolt Through Mount

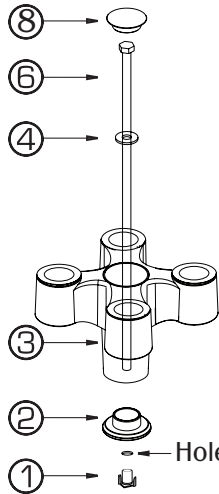

**Required Tools:**  
17 mm socket and extension  
5mm Allen wrench

**Contents:**

#	QTY	Name
1	1	T-Nut
2	1	Base Plate
3	2	Quad Hub
4	1	Washer
5	2	Arm
6	1	* Mounting Bolt
7	2	Adapter Plate
8	1	Washer
8	8	Adapter Plate screw
8	8	Monitor screw

Hole in desk

\* Located in bottom of box

### Adjusting Counter Balance

\* Required Tool: 5mm Allen Wrench

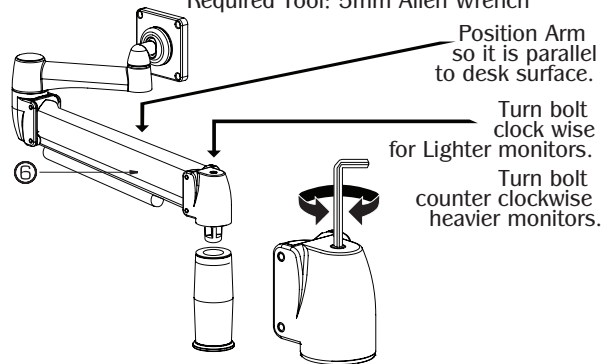

Position Arm so it is parallel to desk surface.

Turn bolt clock wise for Lighter monitors.

Turn bolt counter clockwise heavier monitors.



Use Spacers only when monitor has a recessed 77mm back.

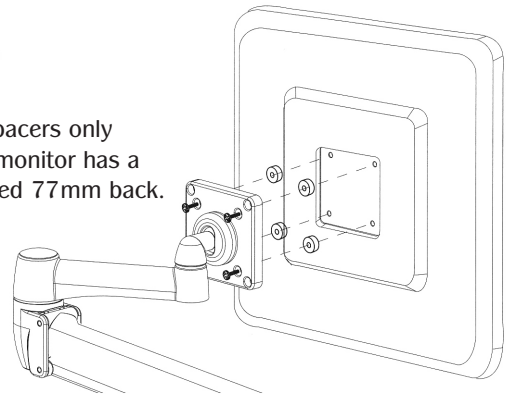

### Adapter Plate

Standard Arm Mount: 75mm  
Adapter Plate: 100mm

- Attach adapter Plate to arm if needed.
- Lay Monitor face down and attach Flat Screen Arm to Monitor.
- Place Flat Screen Arm and monitor into hub and adjust counter balance.

