

Lifestyle Collection

Beautify your Work and Living Space



PCS103B/EE-17S
Pop-Up Kitchen Power

MOCKETT
DOUG MOCKETT & COMPANY, INC

*Why replace your furniture when you can revitalize it with new hardware?
Retrofit options to transform your look.*



DRAWER PULLS & KNOBS	04-21
DOOR HARDWARE	22-27
STANDOFFS	28-29
TABLE LEGS	30-35
FURNITURE LEGS	36-38
CASTERS	39
COAT HOOKS	40-45
PURSE HOOKS	46-47
KITCHEN POWER	48-49
KITCHEN & BATH	50-51
TRASH GROMMETS	52-53
WORK SURFACE SUPPORTS	54-55
SHELF SUPPORTS	56-59
POWER GROMMETS	60
WIRE MANAGEMENT	61
WORK DESK ACCESSORIES	62
PRICING	63-66

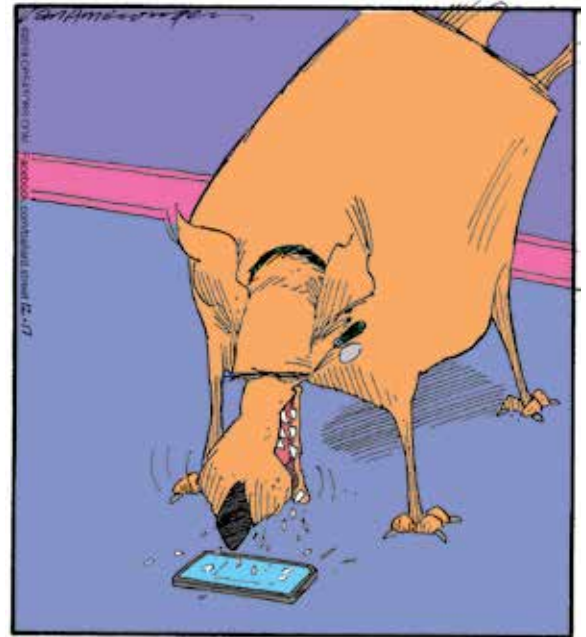

Murphy is allowed to do all the interacting
with telemarketers.

By permission of Jerry Van Amerongen and Creators Syndicate, Inc.

Our Guarantee:

- Call 800-523-1269 to talk to a REAL person
- No Minimums
- 96.5% Same Day Shipping
- Free Return Shipping
- No Restocking Fee

DESIGN: DEFINED BY DETAILS

What separates a great interior design from a mediocre one? The finishing touches of course! “The devil is in the details”, as they say. Premium hardware accents not only add valuable function to your furniture, but also contribute to the overall aesthetic taking your design to the next and best level.



PCS55
Levity Tasklamp

See what a difference the hardware alone can make!

Tab Pulls sit flush with the drawer for a low profile look. We have every size for every application.

DP3 SERIES *Tab Drawer Pulls*



								
3 Polished Brass	10B English Antique	10V Venetian Bronze	12 Brushed Bronze	17S Satin Nickel	21 Black Chrome	26 Polished Chrome	26D Satin Chrome	90 Matte Black

TAB DRAWER PULLS

Classic Design, Contemporary Style. A timeless blend of clean, minimalist details to keep a low profile, but to make a big statement.

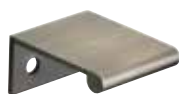

DP3-10B
English Antique



DP3B-21
Black Chrome

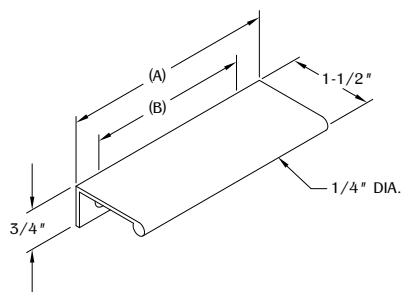

	(A) Length	(B) O.C.
DP3	1 1/4"	5/8"
DP3A	3"	2"
DP3B	4"	3"
DP3C	6"	5"
DP3D	8"	3"
DP3E	10"	4"
DP3F	12"	3 5/16"
DP3G	14"	4"
DP3H	16"	4 21/32"
DP3I	18"	5 11/32"
DP3J	20"	6"
DP3K	22"	6 21/32"
DP3L	24"	7 11/32"

DP3

TAB DRAWER PULL

You will love our classic DP3 Tab Drawer Pulls! A timeless and distinctive look that complements all types of furniture, you can't miss with DP3. Available in a variety of lengths to suit any drawer or cabinet size for a clean and continuous edge with a minimalist style. Custom sizes are easy and economical too! Available in any length up to 8' for your specific application. Select sizes also available with 2" profile. Visit mockett.com for details.

DP3/DR/6

TAB DOOR PULL

If you love the clean and minimalist look of our DP3 Tab Pull Series on drawers, you'll love DP3/DR for larger cabinets, armoires, credenzas, and doors even more! Even with a beefy 3" profile, they sit subtly on any door surface for an unobtrusive look, keeping your furniture looking sleek and contemporary. Choose from four standard lengths, or any custom length can be made for your super-sized furniture.

	(A) Length	(B) O.C.
DP3/DR/6	6"	4"
DP3/DR/8	8"	2"
DP3/DR/10	10"	2 21/32"
DP3/DR/12	12"	3 11/32"



DP3/DR/6-3
Polished Brass



DP3/DR/6-90
Matte Black

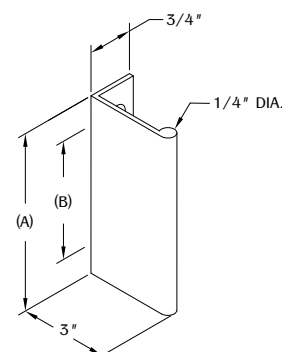

Square Drawer Pulls go with everything. Beautiful in every setting. Too easy!



CLASSIC DRAWER PULLS

Square Drawer Pulls have a classic look and feel with that perfect dash of modern essentials that allow it to settle into literally any design. Square pulls are the safest bet on any vintage or ultra-modern furniture and everything in between.

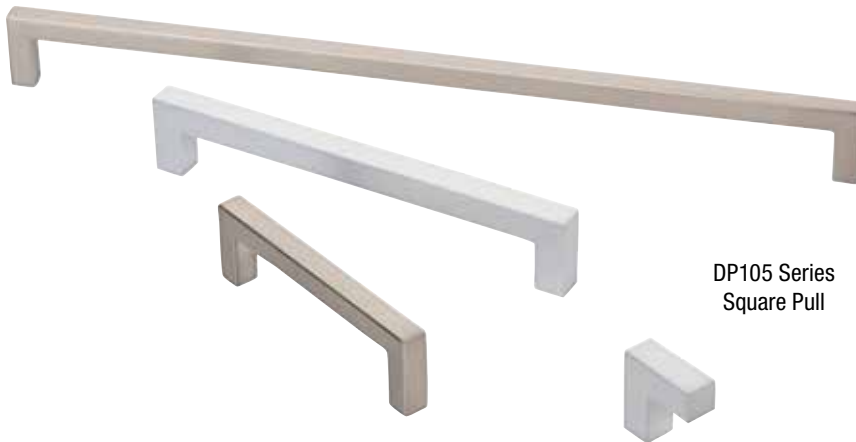

DP105 Series
Square Pull

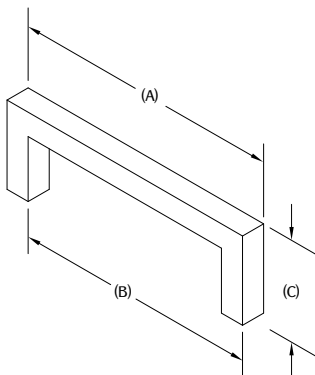

17S
Satin Nickel



26M
Matte Chrome



26
Polished Chrome



SSS
Satin Stainless Steel

DP105

SQUARE PULL

A sleek, modern square bar pull design for the ages. The ultimate mix of beauty and durability. Highly versatile and available in a multitude of different lengths and thicknesses to suit any application. Available in 16 sizes.

	(A) Length	(B) O.C.	(C) Projection
DP105A/6	6 ²⁷ / ₃₂ "	6 ⁵ / ₈ "	1 ²¹ / ₃₂ "
DP105A/8	8 ¹ / ₈ "	7 ⁹ / ₁₆ "	1 ²¹ / ₃₂ "
DP105A/9	9 ³ / ₈ "	8 ¹³ / ₁₆ "	1 ²¹ / ₃₂ "
DP105A/13	13 ¹ / ₁₆ "	12 ¹⁹ / ₃₂ "	1 ²¹ / ₃₂ "
DP105A/18	18 ³ / ₁₆ "	17 ⁵ / ₈ "	1 ²¹ / ₃₂ "
DP105A/20	20 ²³ / ₃₂ "	20 ⁵ / ₃₂ "	1 ²¹ / ₃₂ "
DP105B/1	1 ¹ / ₄ "	N/A	1 ¹ / ₄ "
DP105B/6	6 ³ / ₄ "	6 ⁵ / ₁₆ "	1 ¹ / ₄ "
DP105B/9	9 ⁵ / ₁₆ "	8 ¹³ / ₁₆ "	1 ¹ / ₄ "
DP105C/4	4 ³ / ₁₆ "	3 ²⁵ / ₃₂ "	1 ⁹ / ₃₂ "
DP105C/5	5 ⁷ / ₁₆ "	5 ¹ / ₃₂ "	1 ⁹ / ₃₂ "
DP105C/6	6 ¹¹ / ₁₆ "	6 ⁵ / ₁₆ "	1 ⁹ / ₃₂ "
DP105C/7	7 ¹⁵ / ₁₆ "	7 ⁹ / ₁₆ "	1 ⁹ / ₃₂ "
DP105C/9	9 ³ / ₁₆ "	8 ¹³ / ₁₆ "	1 ⁹ / ₃₂ "
DP105C/13	13"	12 ¹⁹ / ₃₂ "	1 ¹ / ₄ "
DP105C/18	18 ¹ / ₃₂ "	17 ⁵ / ₈ "	1 ¹ / ₄ "

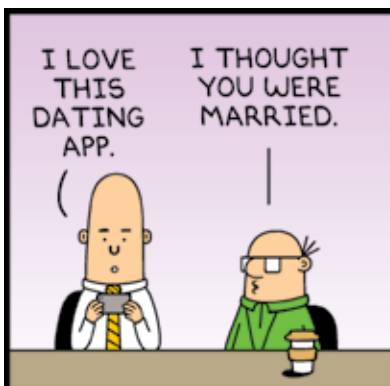

DILBERT © 2017 Scott Adams. Used By permission of ANDREWS MCMEEL SYNDICATION. All rights reserved.

Modern Bar Pulls take a traditional design and add a contemporary twist for an all-around unique and timeless style.



CONTEMPORARY DRAWER PULLS

Striking beauty in perfectly subtle form. Contemporary design calls for a minimalist approach to the overall aesthetic, but emphasizes a meticulous focus on the smallest details.



DP128

ROUND TOP PULL

Classic? Contemporary? You decide! This exciting pull will go with either style and make it stand out. Cast with a round top and square posts for an interesting transitional design and tranquil complementary balance.

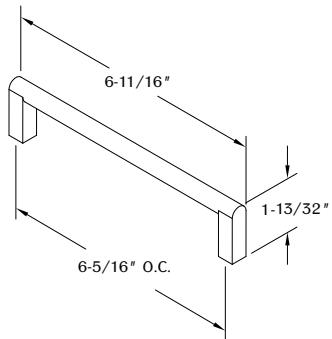

DP128
Round Top Pull

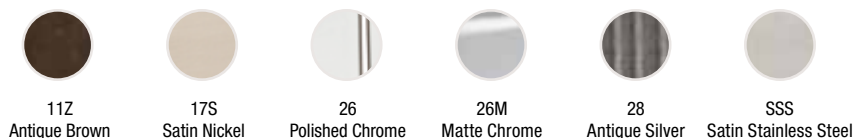

DP177

RECTANGULAR BRACKET PULL

Solid body has a rigid hefty feel with a surprisingly light grip and slight profile when installed. Its slender appearance has a very modern feel on even the most industrial heavy duty applications.

	(A) Length	(B) O.C.
DP177A	7 7/8"	7 9/16"
DP177B	12 29/32"	12 19/32"



17S
Satin Nickel

DP177 Series
Satin Nickel

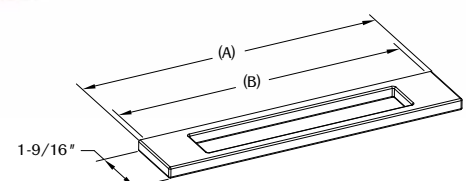

*Stainless Steel has a distinct look like no other.
You'll love the way it looks on your furniture.*



STAINLESS STEEL DRAWER PULLS

There's a reason Satin Stainless Steel never goes out of style. It's sleek and classy, it's easy to clean and maintain, and it looks brilliant on ALL types of furniture! You can't go wrong. And it's built for the toughest environments.



DP54 Series
Satin Stainless Steel

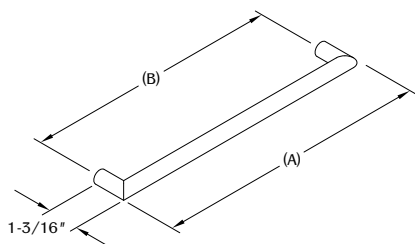

DP54C-SSS
Satin Stainless Steel



SSS
Satin Stainless Steel

DP54

ANGLED BAR PULL

An updated look to a classic stand-by, these wire pulls have a hefty bar stock that gives them a more contemporary feel and a firmer grip surface. Available in 10 sizes to finish off every drawer, large or small, to keep a consistent look across your furniture.

	(A) Length	(B) O.C.
DP54A	4 1/4"	3 25/32"
DP54B	5 1/2"	5 1/32"
DP54C	6 3/4"	6 5/16"
DP54D	8 1/32"	7 9/16"
DP54DE	9 11/32"	8 13/16"
DP54E	11 13/16"	11 11/32"
DP54F	13 1/16"	12 19/32"
DP54G	14 3/8"	13 27/32"
DP54H	19 5/16"	18 29/32"
DP54I	25 11/16"	25 3/16"

DP55

ROD PULL

Beautiful concept, beautiful execution! This rod pull features a large diameter bar mounted onto smaller posts. A distinctly elegant look that has a classic, yet contemporary feel that goes with literally everything. Rod comes with chamfered edges.

	(A) Length	(B) O.C.
DP55A	6 5/16"	3 25/32"
DP55B	7 9/16"	5 1/32"
DP55C	8 13/16"	6 5/16"
DP55D	10 1/16"	7 9/16"
DP55E	11 11/32"	8 13/16"
DP55F	15 1/8"	12 19/32"

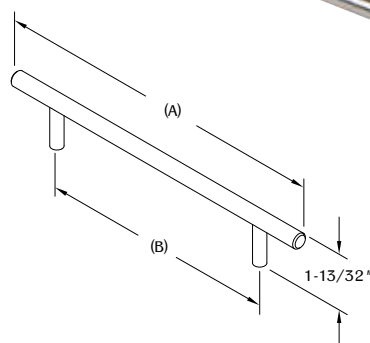
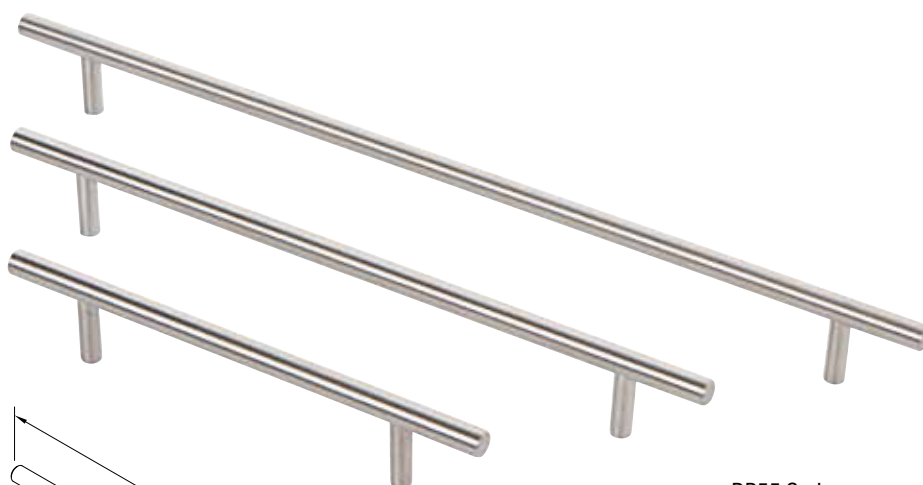

DP55 Series
Satin Stainless Steel



SSS
Satin Stainless Steel

DP56 Series
Satin Stainless Steel



SSS
Satin Stainless Steel

DP56

ROD PULL

Similar to DP55 Rod Pulls, but with a larger diameter for a beefier feel and a sturdier grip for heavier drawers and cabinet doors. Rod mounted onto smaller posts with chamfered edges for a classic, timeless look that goes with all types of furniture.

	(A) Length	(B) O.C.
DP56A	10 ²³ / ₃₂ "	7 ⁹ / ₁₆ "
DP56B	12"	8 ¹³ / ₁₆ "
DP56C	15 ³ / ₄ "	12 ¹⁹ / ₃₂ "

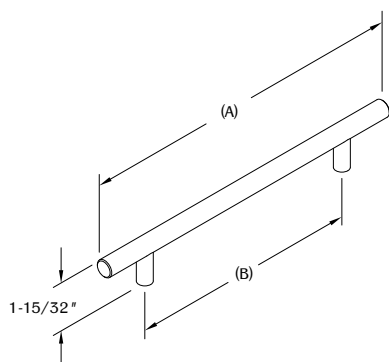

Stainless Steel Rod Pulls are extremely lightweight and surprisingly tough. Durability meets luxury in a chic understated mix of style and function.

DP57

WIRE PULL

Quality wire pulls available in a wide range of sizes from 2" up to 20" to fit every drawer and cabinet door. A basic design that looks great in any size and will really make your furniture sparkle. You can't beat this quality and versatility.

	(A) Length	(B) O.C.
DP57A	2 ⁷ / ₈ "	2 ¹⁷ / ₃₂ "
DP57B	4 ⁵ / ₃₂ "	3 ²⁵ / ₃₂ "
DP57C	5 ⁷ / ₁₆ "	5 ¹ / ₃₂ "
DP57D	6 ³ / ₄ "	6 ⁵ / ₁₆ "
DP57E	7 ¹⁵ / ₁₆ "	7 ⁹ / ₁₆ "
DP57F	9 ¹ / ₄ "	8 ¹³ / ₁₆ "
DP57G	10 ¹ / ₂ "	10 ³ / ₃₂ "
DP57H	11 ³ / ₄ "	11 ¹¹ / ₃₂ "
DP57I	13"	12 ¹⁹ / ₃₂ "
DP57J	16 ¹³ / ₁₆ "	16 ³ / ₈ "
DP57K	19 ⁵ / ₁₆ "	18 ²⁹ / ₃₂ "
DP57L	20 ⁹ / ₁₆ "	20 ⁵ / ₃₂ "



DP57 Series
Satin Stainless Steel

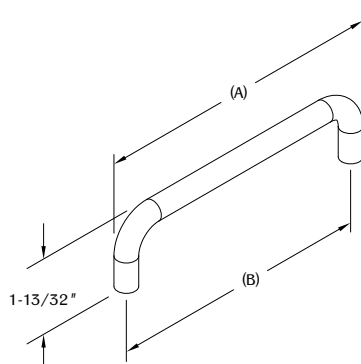

SSS
Satin Stainless Steel



DP129-SSS
Satin Stainless Steel

SSS
Satin Stainless Steel

DP129

FLAT TOP PULL

A unique blend of modern and traditional style. Flat top merges with rounded posts in a solid cast form, opposite the round top and square posts of the DP128 for a different take on the transitional design.

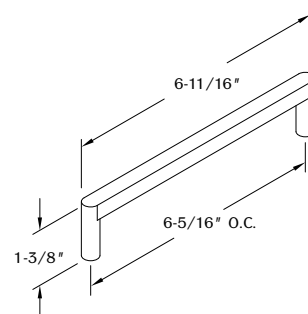

DP32

RADIUSED HANDLE

A flat arched handle rests on two barrels and creates an interesting dichotomy of round and flat that really works well. Transitional design mixes different elements in monochromatic fashion for an intricate blend that is simplistic in nature.

	(A) Length	(B) O.C.	(C) Projection
DP32A/M	5 3/4"	5 1/32"	1 1/8"
DP32B/M	9 3/8"	8 13/16"	1 7/16"

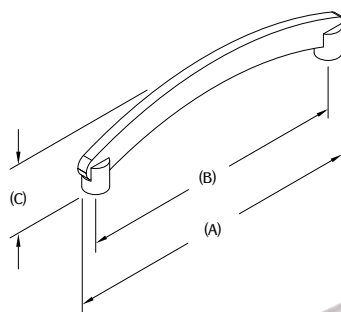

SSS
Satin Stainless Steel



DP32 Series
Satin Stainless Steel

DP157-SSS
Satin Stainless Steel



SSS
Satin Stainless Steel

DP157

ANGLED PULL

This simple yet elegant pull mounts in a routed slot on the top of the drawer surface and screws in from behind. The angled hood provides a comfortable grip and a great look.

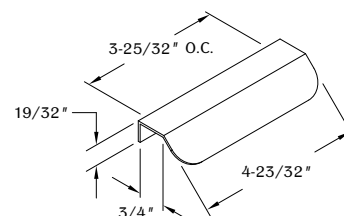

Aluminum Drawer Pulls have a modern feel with a soft, inviting touch. A graceful elegance unmatched by other materials.



DP213

URBAN EDGE PULL

Traditional tab pull design with a fresh new take is now anything but. This unique new look is in a class all by itself. Extremely lightweight with ultra thin construction. Sits nearly flush with the surface. Smooth curves on the downward sloping front edge create a sturdy and comfortable grip. The gap creates an interesting look and contrast with a surprisingly strong crossbar.

	(A) Length	Holes
DP213A	1 ⁹ / ₁₆ "	2
DP213B	7 ⁷ / ₈ "	4
DP213C	13 ²⁵ / ₃₂ "	4



94
Brushed Satin Aluminum

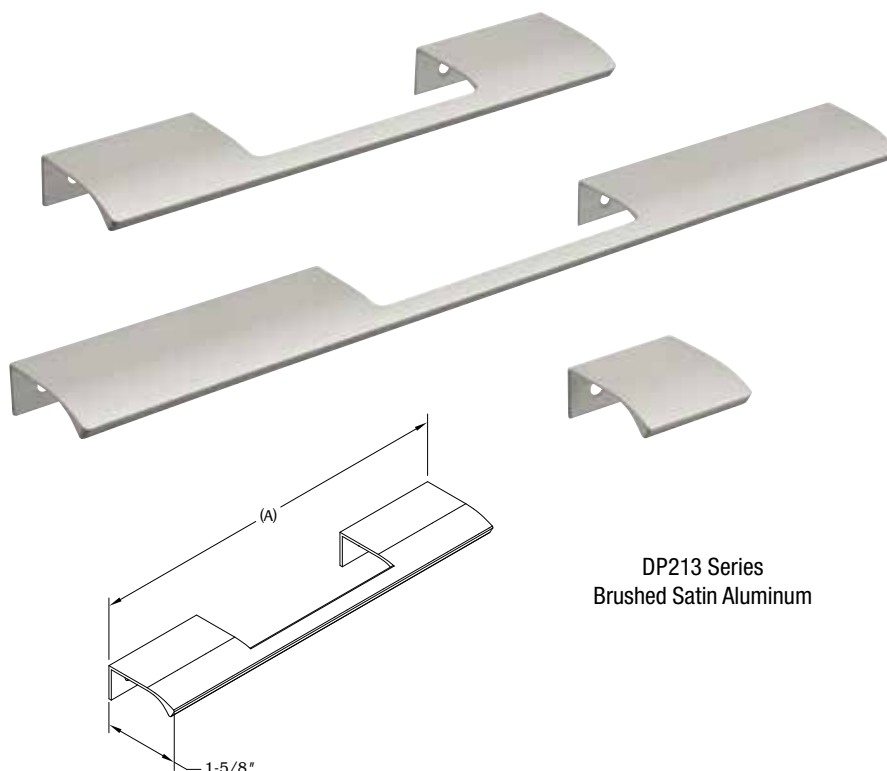

DP213 Series
Brushed Satin Aluminum

ALUMINUM DRAWER PULLS

Aluminum has an extraordinary versatility that is accentuated by its beautiful, inviting allure. Its flexibility gives it the strength and utility of steel with only one third of the weight. Plus, it adds an ultra-contemporary air of sophistication to your furniture.

DP211

STRAIGHT EDGE PULL

A new take on a traditional tab pull design. Extremely lightweight and ultra thin, these pulls sit directly on top of the drawer surface without needing to rout out the top. They're so thin, they're nearly flush as is! Smooth curves and a sloping edge create a sturdy comfortable grip.

	(A) Length	Holes
DP211A	1 ⁹ / ₁₆ "	2
DP211B	7 ⁷ / ₈ "	3
DP211C	13 ²⁵ / ₃₂ "	3



DP211A-24R
Rose Gold



DP211B-15
Dark Bronze



DP211C-94
Brushed Satin Aluminum



4B
Brushed Brass



15
Dark Bronze



22
Brushed Anthracite



24R
Rose Gold



90
Brushed Black



94
Brushed Satin Aluminum

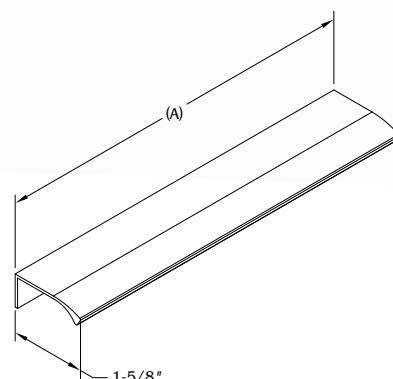

DP120-94
Brushed Satin Aluminum

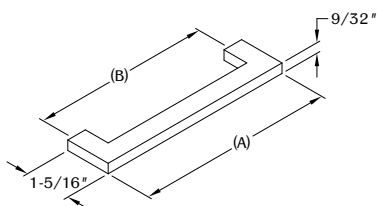

DP120

ALUMINUM RECTANGULAR PULL

We thought our steel square bar pulls could use a softer touch, so we introduced a thinner, rectangular aluminum version that has a soft and inviting allure. You'll love the smooth and comfortable grip.

	(A) Length	(B) O.C.
DP120A	5 ¹⁹ / ₃₂ "	5 ¹ / ₃₂ "
DP120B	6 ²⁷ / ₃₂ "	6 ⁵ / ₁₆ "
DP120C	9 ³ / ₈ "	8 ¹³ / ₁₆ "



94
Brushed Satin Aluminum

*Recessed Handles are great for
drawers, cabinets, and pocket doors.*



RECESSED PULLS

You'll love our collection of Recessed Handles. Shallow grip cavity deep enough for leverage but slight enough to maintain a nearly flush appearance. Great for tight spaces and sliding doors too!

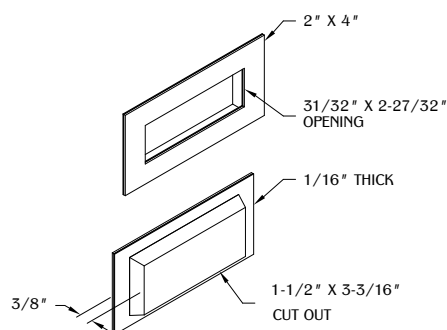

DP156

RECESSED RECTANGULAR PULL

Recessed into your door or drawer for a flush and seamless integration. Its sharp lines give it a very serious contemporary feel and its recessed cavity traps and casts light with some interesting highlights.



SSS
Satin Stainless Steel

DP222

TRINITY PULL

Rounded, rectangular, and recessed into your furniture with an inset opening. The trim flange overlay provides a grip inside the hollow chamber. Rounded edges give a traditional feel and soften the appearance on your furniture to make a more fluid integration.



17S
Satin Nickel

	(A) Length	(B) O.C.
DP222A	5 ²¹ / ₃₂ "	5 ¹ / ₃₂ "
DP222B	8 ³ / ₁₆ "	7 ⁹ / ₁₆ "

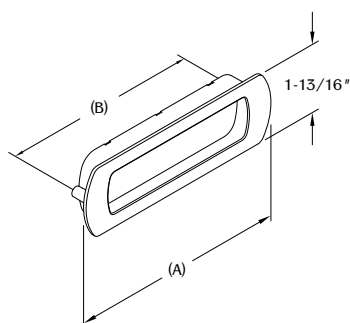

DP222 Series
Satin Nickel



*Exquisite Slimline Pulls create a striking contrast on your furniture.
The perfect complementary accent.*

SLIMLINE BAR PULLS

Slimline Bar Pulls have a contemporary style that is somehow both bold and sedate at the same time. Custom accents for your one-of-a-kind furniture. Great for large drawers to make them seem even longer.

DP148

ELEGANT BAR PULL

Elegant and modern - these understated pulls are, amazingly, both subtle and striking. Thin frame is easy to grasp and maintains an extremely low profile for a seamless integration into any contemporary furniture.

	(A) Length	(B) O.C.
DP148A	8 1/8"	7 9/16"
DP148B	10 5/8"	10 3/32"
DP148C	18 3/16"	17 5/8"



17S
Satin
Nickel



26
Polished
Chrome



26M
Matte
Chrome



91B
Brown
Black



DP148 Series
Bar Pull

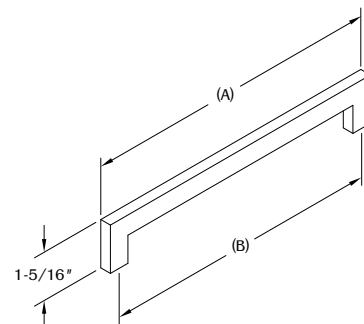

DP238 Series
Satin Nickel

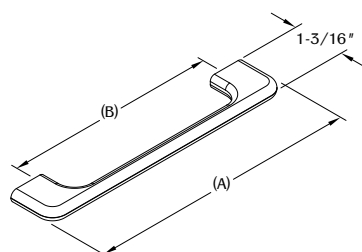

DP238

LOFT PULL

Modest shape has a universal appeal on all types of furniture. Clean rounded contours subtly accentuate your furniture with a gentle softness that eases into the overall design.

	(A) Length	(B) O.C.
DP238A	6 5/8"	5 1/32"
DP238B	11 21/32"	10 3/32"



17S
Satin
Nickel

BOW HANDLES

These curved pulls have a soothing and graceful arch that gives just enough clearance off the drawer face for a modest grip area, but its sloping ends keep an aerodynamic look on both large and small drawers.

DP7

BOW DRAWER PULL

A beautifully sleek steel bow with a flat undercut. For smaller drawers, the smallest version has a more rounded bow shape and for larger drawers, the largest version has a longer, leaner body. All four sizes have a subtle and chic complementary shape that goes with all types of furniture.

	(A) Length	(B) O.C.	(C) Projection
DP7A	3"	2 17/32"	1"
DP7B	4 3/8"	3 25/32"	1"
DP7C	5 13/16"	5 1/32"	1 1/16"
DP7D	8 7/8"	7 9/16"	1 1/16"



DP7 Series
Bow Drawer Pull

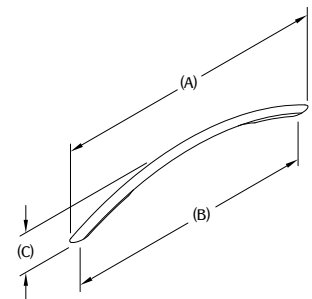
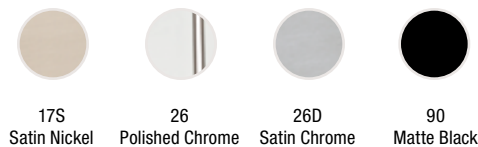

DP33

BOW HANDLE

A traditional design that is simply elegant. You can't go wrong with a classic, and we think ours is quite exquisite as it is made slightly heavier than most with a 3/8" diameter. Available in six lengths for matching on different sized drawers and cabinets.

	(A) Length	(B) O.C.	(C) Projection
DP33A	4 1/2"	3 27/32"	1 3/16"
DP33B	5 15/16"	5 1/32"	1 7/32"
DP33C	7 7/16"	6 5/16"	1 9/32"
DP33D	8 3/4"	7 9/16"	1 3/16"
DP33DE	10 3/16"	8 13/16"	1 1/4"
DP33E	14 5/8"	12 5/8"	1 1/4"

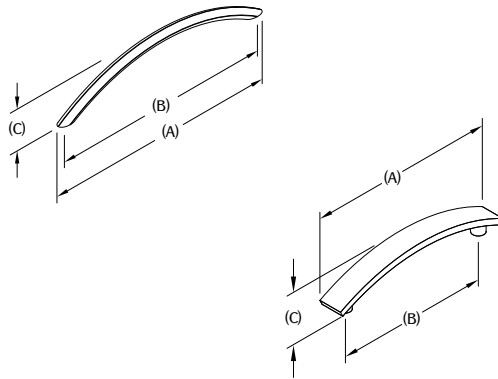

DP33 Series
Satin Stainless Steel



SSS
Satin Stainless Steel

DP78

CURVED BAR PULL

Flat stock curved bar mounts onto subtle round posts that are hardly visible giving the illusion of a floating arch pull. This timeless conservative design has taken on a bold and contemporary twist that is equally at home on traditional and modern furniture and cabinetry.

	(A) Length	(B) O.C.	(C) Projection
DP78C	4 17/32"	3 25/32"	29/32"
DP78D	5 3/4"	5 1/16"	1"
DP78E	9 17/32"	8 13/16"	1 3/16"



DP78 Series
Curved Bar Pull

KNOBS

For those smaller drawers and cabinets, you'll love our collection of Knobs. All in brilliant finishes and stylish form.

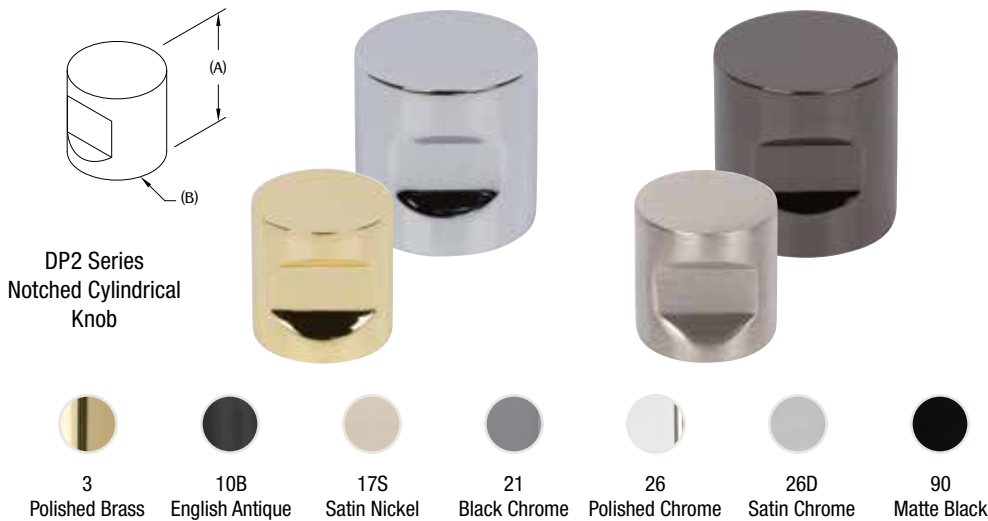

DP2

NOTCHED CYLINDRICAL KNOB

Traditional knob machined from brass with undercut finger grip. Modest in size and footprint on the drawer or cabinet face, but hefty in weight and feel, and big on details that will complement your furniture! Can also be mounted on a wall and used as a stylish coat hook.

	(A) Projection	(B) Diameter
DP2	7/8"	7/8"
DP2A	1 1/8"	1 1/8"

DP250

KNURLED KNOB

Classic retro feel for your vintage or contemporary industrial furniture. Intricate knurling provides a unique look and a wonderful texture for gripping. Finished top and beveled edges give it an especially attractive finishing touch for your one of a kind furniture.

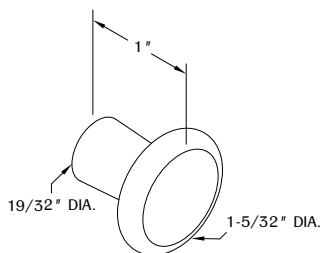

DP196-SSS
Satin Stainless Steel

DP196

MUSHROOM PULL

Mushroom shaped with a smooth, flat top great for use as a pull or a coat hook. Small, simple, and extremely functional with a great finger grip that provides a hearty and comfortable grasp. Beautiful shine and big on details.

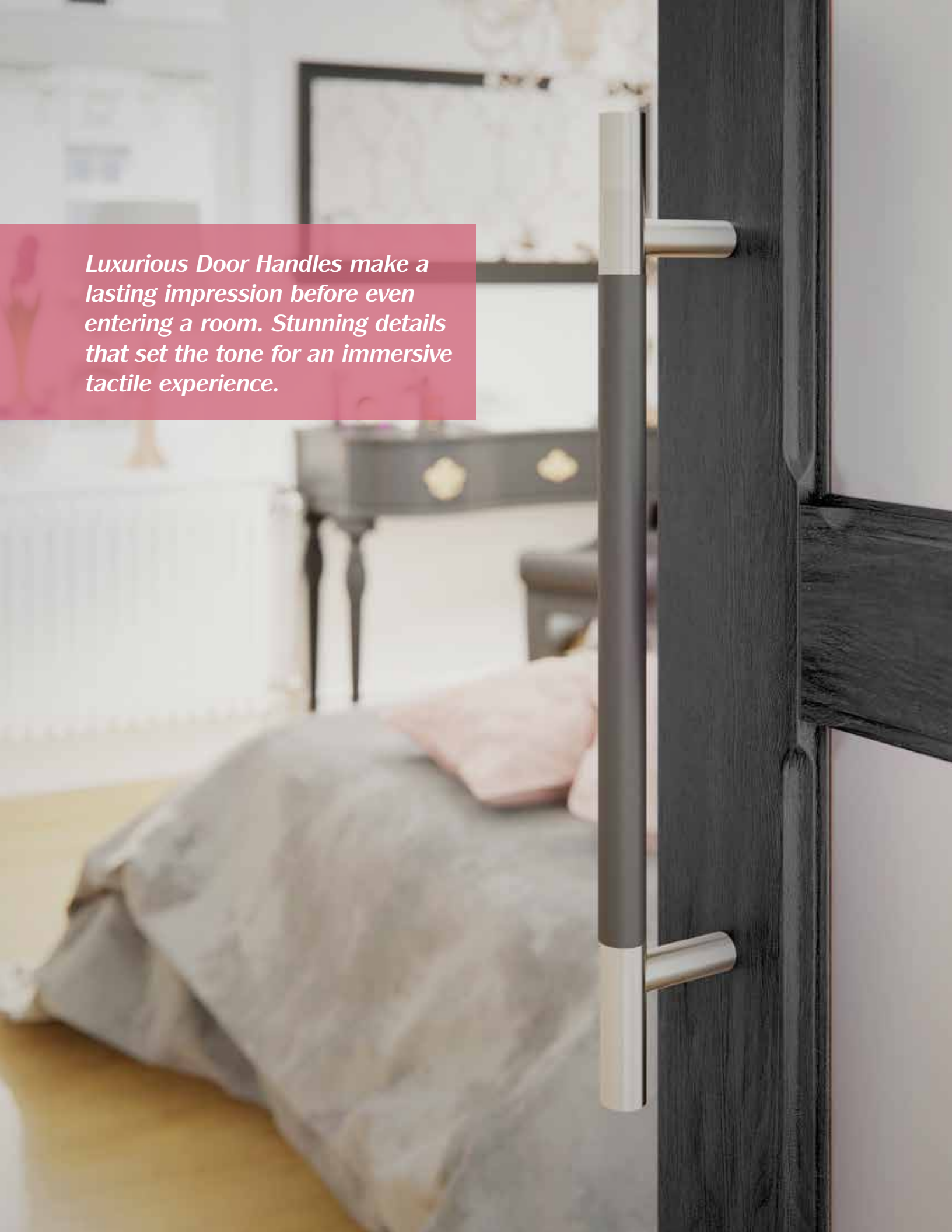
A black door with a modern silver handle is the central focus. The door is slightly ajar, revealing a room with a bed covered in a grey blanket and a pink pillow. In the background, a dark wooden desk with gold-colored drawers is visible. The text is overlaid on a pink rectangular background on the left side of the image.

Luxurious Door Handles make a lasting impression before even entering a room. Stunning details that set the tone for an immersive tactile experience.

DOOR HANDLES

Interior Doors have never been so seductive. Our Door Handles will add a delightful complementary touch to your interior with inspired designs and exquisite materials, including Aluminum, Steel, and hand-stitched Leather bound handles.

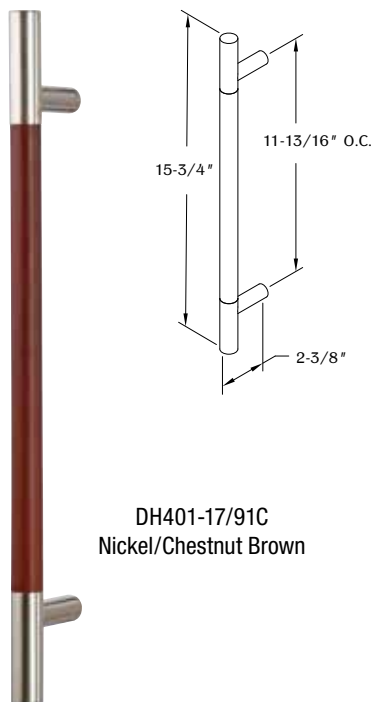

DH401-17/91C
Nickel/Chestnut Brown



DH401/BB-17/91C
Nickel/Chestnut Brown

DH401

SLIM BARREL DOOR HANDLE

Stunning leather door handles! Inspired by their smaller drawer pull counterparts, this popular design looks even more ravishing on a larger scale. Hand stitched leather wrap gives a beautiful complementary finishing touch. Sold individually, DH401, or in pairs with back-to-back mounting hardware, DH401/BB.



17/90
Nickel/Black



17/91C
Nickel/Chestnut Brown



17/91H
Nickel/Chocolate Brown

DH4

SLIM CYLINDRICAL DOOR HANDLE

Round bar handle has a classic style that complements any door type. Classic shape is extremely popular with drawer pulls and cabinet handles and lends itself to larger door applications to match existing interior design. Sold individually, DH4, or in pairs with back-to-back mounting hardware, DH4/BB.



17S
Satin Nickel



26
Polished Chrome



26D
Satin Chrome



DH4/BB-17S
Satin Nickel

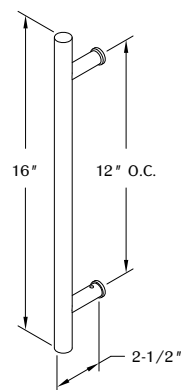

DH4-17S
Satin Nickel



Barn Door Hardware spices up your décor with a taste of rustic chic! A great space saving tool for smaller spaces too.



SLIDING DOOR HARDWARE

Use with any interior door to turn any open floor space into a private room with an easy-gliding sliding door. Transform your urban loft with a touch of farmhouse flair, or vice versa giving your rustic décor a metro makeover.

SDH4

MINI SLIDING DOOR HARDWARE SET

We loved the barn door look on full sized doors so much, we had to scale it down to a toy-sized version to enjoy on smaller furniture too! Imagine the charming allure of a sliding door set on a beautiful bar or buffet, or on an entertainment center or mantle display to conceal a television when not in use. How about a restroom vanity or storage dresser cabinet set? Any furniture with a traditional hinged swing door can be converted into a lovely barn door system. This pint-sized version of its larger predecessor is adorable on all furniture types and adds an unexpectedly delightful grace to the design - a simple touch that creates a wonderful charisma that radiates throughout the room.



SDH4-90
Black

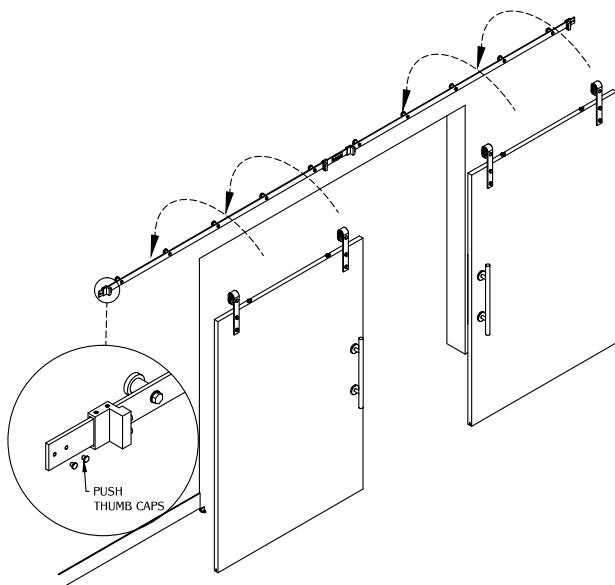
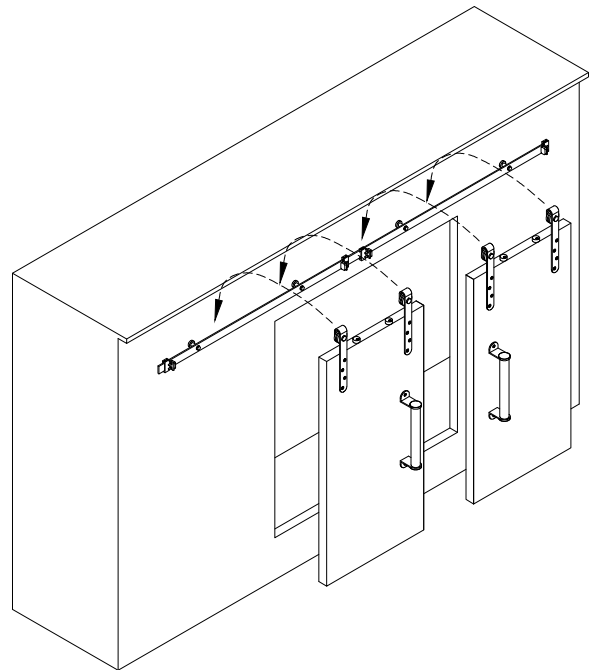

SDH3

DOUBLE DOOR SLIDING DOOR HARDWARE SET

Give your beautiful interior a contemporary transformation with a picturesque double door opening. Great for home or office to create a stunning entryway into your conference room or foyer, or seal off a large room or passageway for privacy with large, beautiful custom doors. Works with wood, glass, or any other door type. Let your imagination run wild with possibilities. Enjoy the two tone effect created by the black bracket set and charcoal grey rod, a beautiful complementary combination that further explores the dichotomy of rustic chic and contemporary elegance.



SDH3-90
Black



SDH1

SLIDING DOOR HARDWARE

Barn Door Hardware is a great space saving tool! SDH1 can be applied to any interior door, including glass, and glides easily over the track. Give your space a decorative rustic feel and spice up your décor with some elegant country chic. Ultra-modern stainless steel hardware creates an interesting dichotomy of contemporary style and farmhouse function. Back-to-back door handles included as shown.



SSS
Satin Stainless Steel

SDH2

SLIDING DOOR HARDWARE

Want to give your interior space a rustic feel with a contemporary twist? Barn Door Hardware provides the perfect space saving solution for your interior door with easy-gliding operation for lofts, offices, closets, or anywhere a transitional space is needed. Ideal for smaller spaces that don't have the room for a traditional swing-door, and for larger spaces that want to keep that open free flowing feel. Back-to-back door handles included as shown.



SSS
Satin Stainless Steel



ZITS © 2009 Zits Partnership - Distributed by King Features Syndicate, Inc.

DOOR STOPS

Door Stops can be so much more than those boring little rubber wedges. Fine decorative details are what give exceptional work and living spaces an edge.

DS2

ROUND DOOR STOP

Modern design and low profile bumper make this door stop perfect for contemporary households and businesses. Comes with wood screw for wood floors and molly for composition floors.



94
Satin Aluminum



SSS
Satin Stainless Steel



DS2-94
Satin Aluminum

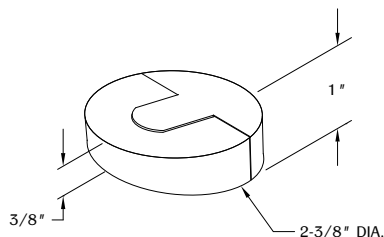

DS3

CYLINDRICAL DOOR STOP

Post available in Satin Stainless Steel or Aluminum, this post with hefty black rubber bumper has a unique roller style.



94
Satin Aluminum



SSS
Satin Stainless Steel



DS3-SSS
Satin Stainless Steel

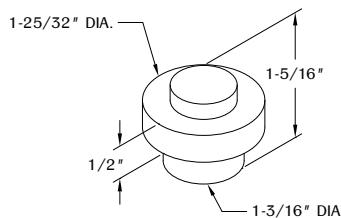

DS6

CYLINDRICAL DOOR STOP

A simple and clean design with a rubber bumper ring available in four beautiful finishes. Two sizes, 1 3/16", DS6, and 1 1/16", DS6A.



3
Polished Brass



17S
Satin Nickel



26
Polished Chrome



26D
Satin Chrome



DS6-3
Polished Brass

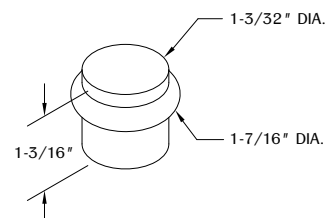

*What a way to display!
Standoffs are right up
your creative alley for
signage, art, and more.*

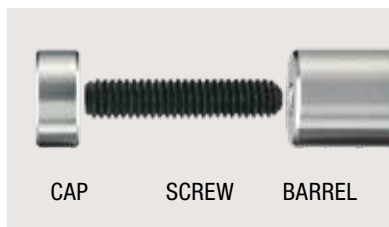
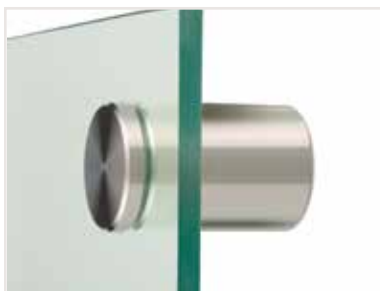

*Every size for every job.
Available in custom colors too!*



Stainless Steel



Aluminum



Regular Cap



Low Profile Cap



Mounting Options For: Wood, Concrete, Drywall and Table Top

STANDOFFS

Standoffs allow you to display artwork or signage, raise a transaction top above a desk or work surface, hang a modesty panel; the options are endless. All in quality machined aluminum and stainless steel.

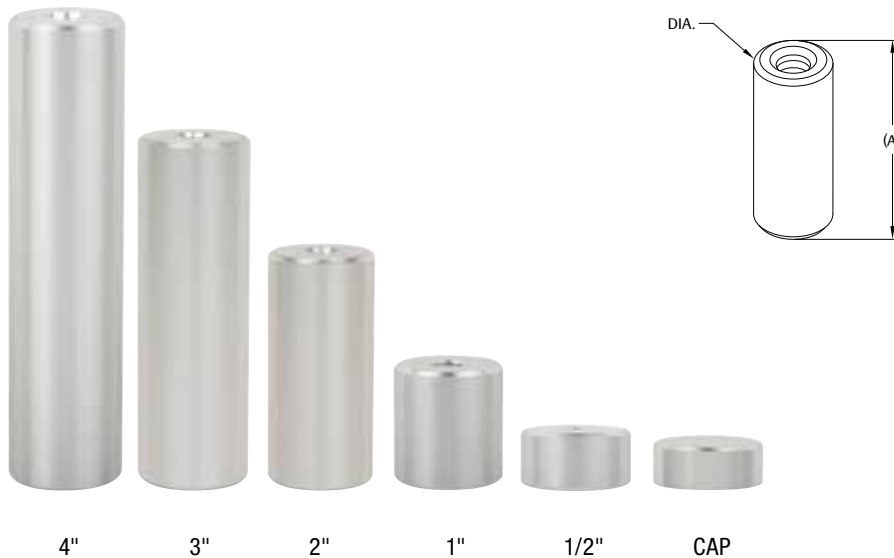

MPB COLLECTION

MULTI-PURPOSE STANDOFFS

Standoffs are right up your creative alley! Available in a variety of lengths and thicknesses to suit your custom application. You can even create dynamic displays and step out your display with multiple levels. Available in round or square in Satin Aluminum. Select sizes also available in Satin Stainless Steel. See website for details.



94
Satin Aluminum

(A)	MPB6 3/8" DIA.	MPB7 5/8" DIA.	MPB9 1" DIA.	MPB10 1-1/4" DIA.	MPB11 1-1/2" DIA.	MPB12 2" DIA.	MPB/SQ 1" SQ.
1/4" height	X			X			
1/2" height	X	X	X				
5/8" height				X			
3/4" height		X					
7/8" height							
1" height	X	X	X	X	X	X	X
1 1/2" height		X					
2" height		X	X	X	X	X	X
3" height		X	X	X	X	X	
4" height			X	X	X	X	
6" height				X		X	
8" height				X			
10" height				X			
12" height				X			



Our signature Table Legs are the finest legs around! We are thrilled to bring you our collection. Enjoy the artistry.

TABLE LEGS

We have tried to cover every style imaginable to suit your contemporary furniture. Most of our legs are available in standard sizes, others can be customized to your exact specifications. From classic to modern, we have exactly what you need.

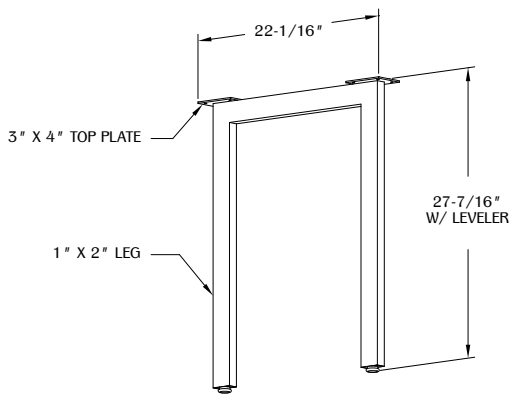

TL37

RECTANGULAR LEG W/SCREW MOUNT

These striking steel legs have a simple, elegant form that provides a pristine complementary touch to your custom table top. If you're looking for a clean and luxurious design without a lot of extraneous elements that serve as a distraction from your overall aesthetic, these legs are apt for the job. Available in a single leg, TL37A, or a dual leg, TL37B.



26D
Satin Chrome



90
Matte Black

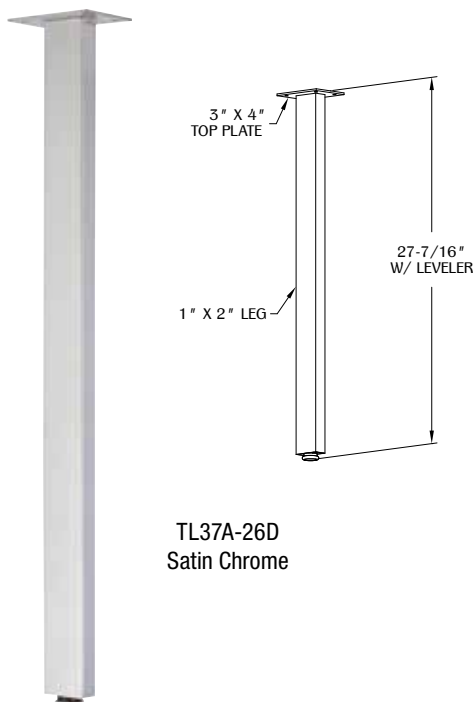

By permission of Jerry Van Amerongen and Creators Syndicate, Inc.



We specialize in the finishing touches that make your furniture look stunning. Look no further than our signature Table Legs. Give your custom table top the beautiful accent it deserves.

SIGNATURE TABLE LEGS

Our collection of Designer Table Legs will inspire awe and delight, but their true beauty stems from their ability to complement the overall design. While handsome enough to take center stage alone, they serve simply to enhance the presentation as a whole.

TL63

CASCADE LEG

Transitional table leg is defined by its distinctly gentle sloping contours and creates a striking presentation on your custom furniture! Its antique origins take flight in contemporary form with a tranquil fluidity. A stunning combination of soft and smooth lines that come together to create beautiful harmony. Weight Capacity: 250 lbs



TL63-15
Dark Bronze

TL64

TAGLIO TABLE LEG

Give your furniture a modern twist! An incredible design of mystical proportions, this rigid labyrinth has a distinct floating center sphere that is supported by individual blades that meet at the base to create a union of independent elements. Weight Capacity: 300 lbs



TL64-SSS
Satin Stainless Steel

TL65

IMPERIAL LEG

Four individual blades come together at the base to form a powerful statement. High impact hard lines give a handsome complementary accent to your custom furniture. Your contemporary space deserves an earnest attention to detail and TL65 gives you exactly that – a sober design with an awe-inspiring reverence for the overall aesthetic. Weight Capacity: 250 lbs



TL65-26
Polished Chrome

ORIGINAL “GREAT LOOKIN’ LEGS®”

*Even the most basic shapes require painstaking attention to detail.
Classic style and simple elegance suitable for any job.*

TL27-34

TRADITIONAL TABLE LEGS

Round tube legs have a classic style and a highly versatile soft, familiar shape that goes with everything. Our original Great Lookin’ Legs® are available in a variety of sizes with plate or glide leveler options and if you can't find exactly the size you're looking for, custom options are easy and economical with reasonable lead times. Standard in 3", 4", or 6" diameters in 27 ½", 28", or 34 ½" heights for desk, dining, or bar heights.



26
Polished Chrome



26D
Satin Chrome



90
Matte Black



TL27P-3-26D
Satin Chrome



TL28P-3-26
Polished Chrome



TL34P-3-90
Matte Black

*All available in 3", 4" or 6" diameter in
27", 28 ½" or 34 ½" height. Or to your
own custom specifications.*

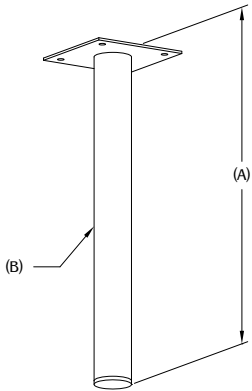

	(A) Height	(B) Size	Regular Leveler	Plate Leveler
TL27	27"	3" DIA.	TL27R	TL27P
	27"	4" DIA.	TL27R	TL27P
	27"	6" DIA.	TL27R	TL27P
TL28	28-1/2"	3" DIA.	TL28R	TL28P
	28-1/2"	4" DIA.	TL28R	TL28P
	28-1/2"	6" DIA.	TL28R	TL28P
TL34	34-1/2"	3" DIA.	TL34R	TL34P
	34-1/2"	4" DIA.	TL34R	TL34P
	34-1/2"	6" DIA.	TL34R	TL34P

Available with Regular Glide or Plate Leveler



Regular Glide Leveler

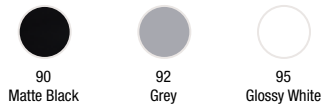

Plate Leveler

TL66

FORTRESS LEG

Give your furniture an air of sophistication with this intriguing design. A union of brutalist style and modern simplicity that creates a unique brand of architectural prowess. Independent slats transform its basic conical shape into slotted chambers, adding depth and dimension to its intricate display. Made to order to your exact specifications. Weight capacity: 250 lbs.



TL66-90
Matte Black

Provocative Design. Exquisite Craftsmanship. Find your inspiration with the details that make your furniture stand out!

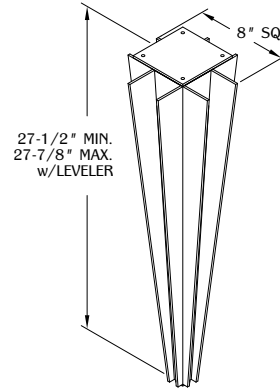

TL67

ELEVATE LEG

Simple tapered leg design is dissected into sectional planes that converge at the base and share a center platform. Stunning artistry manifested through its modest contemporary form. A dichotomy of minimalist design and meticulous tranquility. Made to order to your exact specifications. Weight capacity: 250 lbs.



SSS
Satin Stainless Steel

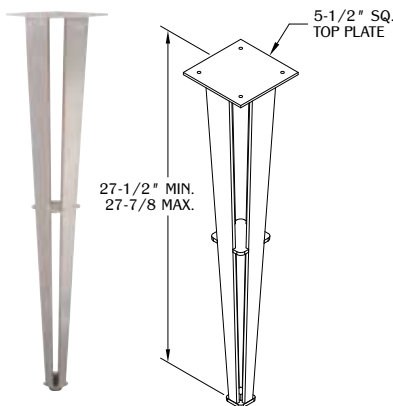

TL67-SSS
Satin Stainless Steel

TL54

WHITLEY LEG

Flat planes combined to give a sense of a solid, curving leg with visual interest increased by the negative space between the plates. A simple design defined by its inherent intricacies of merging contours. Available in two sizes, 27 1/8" height, TL54A, or 34 1/2" height, TL54B. Weight Capacity: 140 lbs

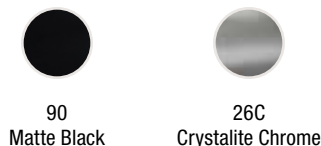

90
Matte Black

26C
Crystalite Chrome

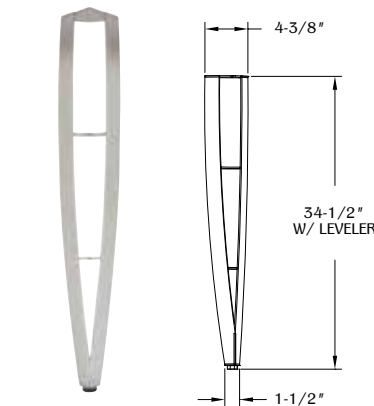

TL54B-26C
Crystalite Chrome

TL47

LOOP TABLE LEG

Beautiful Loop Legs are sure to impress on your custom furniture! A sensory exploration that takes an illusionary effect from its multiple bends of laser-cut steel is met with a surprisingly strong weight capacity for its angle to vertical shape. Base features an adjustable glide leveler. Available in 27 11/32" height, TL47A, and 34 1/2" height, TL47B. Weight capacity: 100 lbs

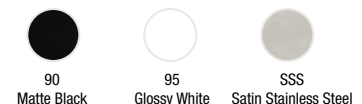

90
Matte Black

95
Glossy White

SSS
Satin Stainless Steel



TL47B-90
Matte Black



*Our Furniture Legs may be small in stature,
but they are big on details. Let no area
of style go unnoticed on your furniture.*

SMALL (LI'L) FURNITURE LEGS

Our Small (Li'l) Furniture Legs come in a variety of heights, sizes, and finishes. From basic tube legs in round or square to awe-inspiring designs, you'll find exactly what you're looking for.

FL19

ALUMINUM FURNITURE LEG

Luxurious furniture legs cast with a decorative tapered shape and an offset top plate for mounting. Hefty arm projects outwards from the mounting bracket, then tapers downwards to a narrow base. Sturdy steel construction with a surprisingly thin profile. Fixed leveler attached. Weight Capacity: 200 lbs



FL19-15
Dark Bronze

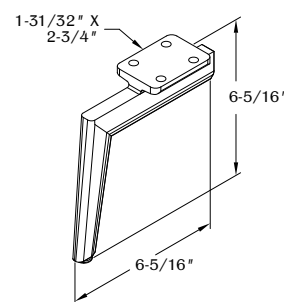

15
Dark Bronze



90
Matte Black



90G
Glossy Black



95
White



100
Polished Aluminum

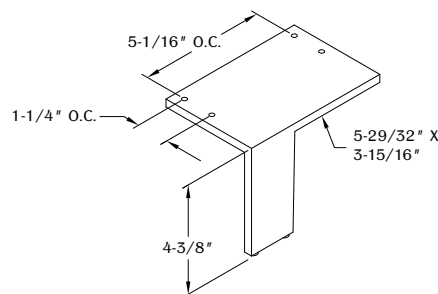

FL16/L-23
Metallic Silver

FL16

SLIM CORNER LEG

Slim furniture leg available in a left and right version, sold individually, continues the line created by the corner of your furniture and carries it down to the floor. A wide profile on one side and a narrow edge on the other gives this leg an interesting look from any perspective. Weight capacity: 175 lbs



17S
Satin Nickel



23
Metallic Silver



26
Polished Chrome



90
Matte Black

FL2

CURVED FURNITURE LEG

Polished aluminum curved tube that is simply elegant. Comes with triangular top plate. Available in 5 $\frac{5}{8}$ " height, FL2/LV1, 6 $\frac{1}{8}$ " height, FL2/LV8, or 6 $\frac{3}{16}$ " height, FL2/LV10, each with a different style leveler for a different look.



FL2/LV1-100
Polished Aluminum

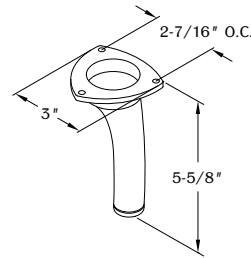

FL22

SPHERE FURNITURE LEG

You've never seen a furniture foot like this before! Self-leveling sphere is cast of solid aluminum and features rhythmic cuts throughout for an illustrious creative design edge. Solid orb is extremely dense, providing a substantial load capacity for even the largest armoires and dressers. This handsome base is sure to create a sleek ultra-modern feel for your contemporary furniture. Weight capacity: 250 lbs



90
Satin Black



92A
Satin Grey



94
Satin Aluminum



FL22-92A
Satin Grey

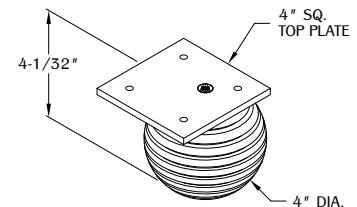

FL3

SMALL FURNITURE LEG

Straight steel tube legs are easy and economical, and with a classic shape and style, they go with virtually everything. Weight capacity: 100 lbs



26
Polished Chrome



26D
Satin Chrome



90
Matte Black



FL3-90
Matte Black

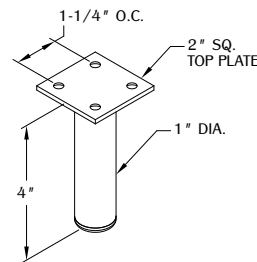

FL5

TAPERED LI'L LEG

Tapered leg going from 2" to 1" at the bottom with a 3" top plate. Conical shape gives a wonderful mid-century feel with a hip, contemporary vibe. Comes with adjustable glide leveler. Weight capacity: 75 lbs per leg



PSS
Polished Stainless Steel



SSS
Satin Stainless Steel



FL5-PSS
Polished Stainless Steel

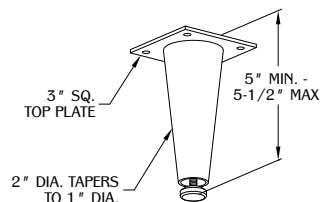

CASTERS

Casters affix to the bottom of furniture, allowing you to move heavy pieces without putting out your back. Practical, but usually not very exciting.

We prefer some pizzazz on top of basic utility.

CA31/CA32

TWIN WHEEL CASTER

Casters are a fun and functional furniture accessory, and with 12 hub insert finishes to choose from, you'll find that perfect complementary accent. Make your furniture mobile with the help of our attractive twin wheel casters. Available with brake, CA31, or no brake, CA32, all with plate or stem mount options. All casters swivel 360°. Weight capacity: 100 lbs



CA31SC-26
Polished Chrome



CA32SN-17S
Satin Nickel

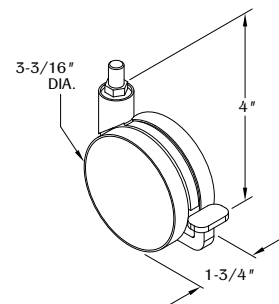

17S
Satin
Nickel



23
Metallic
Silver



26
Polished
Chrome



60T
Translucent
Green



62T
Translucent
Blue



66T
Translucent
Red



86
Cherry



87
Beech



90
Matte
Black



92
Grey



95T
Translucent
White



97T
Translucent
Yellow

CA6

SINGLE CASTER

Nicely curving base, beautiful painted plastic or wood center. Plastic center is rounded and radiused, wood center deeply dished. Available with a Black or Aluminum base with or without a brake and with a plate or stem mounting option. Weight capacity: 25 lbs



23
Metallic
Silver



90
Matte
Black



CA6SA-23
Metallic Silver



CA55CA-53
Orange

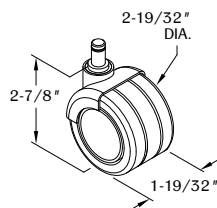
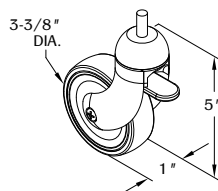

CA55

HOLLOW WHEEL CASTER

Hollow wheel design with two thin tires rotating around a circular hub. Low center of gravity and wide twin-wheel base gives a stable footing and glides smoothly across the surface. Base color of Black, White, or Aluminum with four wheel color options. All available with plate, stem, or chair mount options. All casters swivel 360°. Weight capacity: 70 lbs



53
Orange



90
Matte
Black



92
Grey



92L
Light
Grey



Why are Coat Hooks hidden away in closets and mudrooms? Probably because most humdrum designs are so downright boring. Our inspired designs will change your take on everything.

CH23

BUTTON COAT HOOK

This delightful button coat hook goes anywhere! Subtle design settles into your interior seamlessly and can be used for coats or kitchen or bath towels. Timeless design with versatile purpose - a winning combination!



3
Polished Brass



23
Metallic Silver



PSS
Polished Stainless Steel



SSS
Satin Stainless Steel

	(A) Dia.	(B) Projection	(C) Dia.
CH23	25/32"	1 3/8"	1 3/8"
CH23A	25/32"	1 1/32"	25/32"



CH23-SSS
Satin Stainless Steel



CH23A-PSS
Polished Stainless Steel

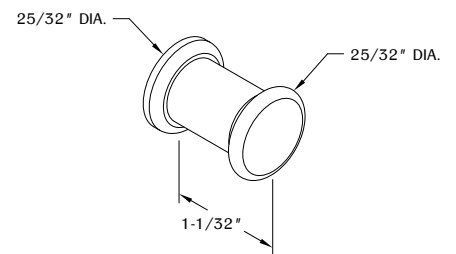
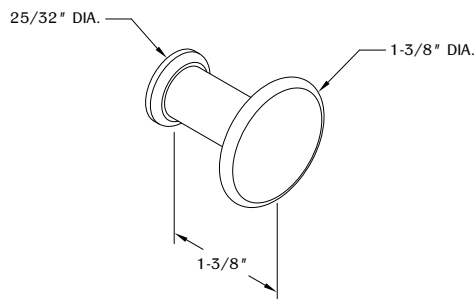

COAT HOOKS

*Our exquisite Coat Hook collection is fun and functional. Why shouldn't it be?
With such high visibility in entryways, we like to turn them into
decorative accent pieces!*

HK27

FLAT TOP BUTTON HOOK

Coat Hooks don't get any easier than this. Minimalist style and clean, traditional finishes give this timeless hook set a classic look that goes with anything. Three straight posts with flat caps mounted onto a simple back plate to conceal the mounting hardware. Available with a 7" back plate, HK27K-A, or a 9 1/4" back plate, HK27K-B. Or the hooks can be used singly and purchased individually, HK27.



90
Satin Black



92A
Satin Grey



94
Satin Aluminum

	Hooks	(A) Length	(B) O.C.
HK27	1	N/A	N/A
HK27A	3	7"	3"
HK27B	3	9 1/4"	4"



HK27-94
Satin Aluminum



HK27K-A-94
Satin Aluminum



HK27K-B-90
Satin Black

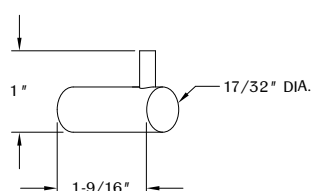
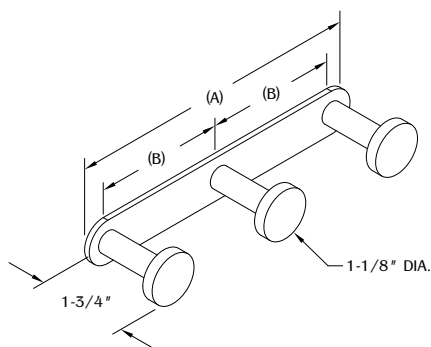

HK2A

POST HOOK PAIR

These simple hooks on a post will enhance any style kitchen, bath or closet. Sold as a pair.

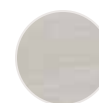

SSS
Satin Stainless Steel



HK2A-SSS
Satin Stainless Steel

*Who says Coat Hooks are just for coats?
Put this piece of art on full display and have
some fun with our Kangaroo Coat Hook!*

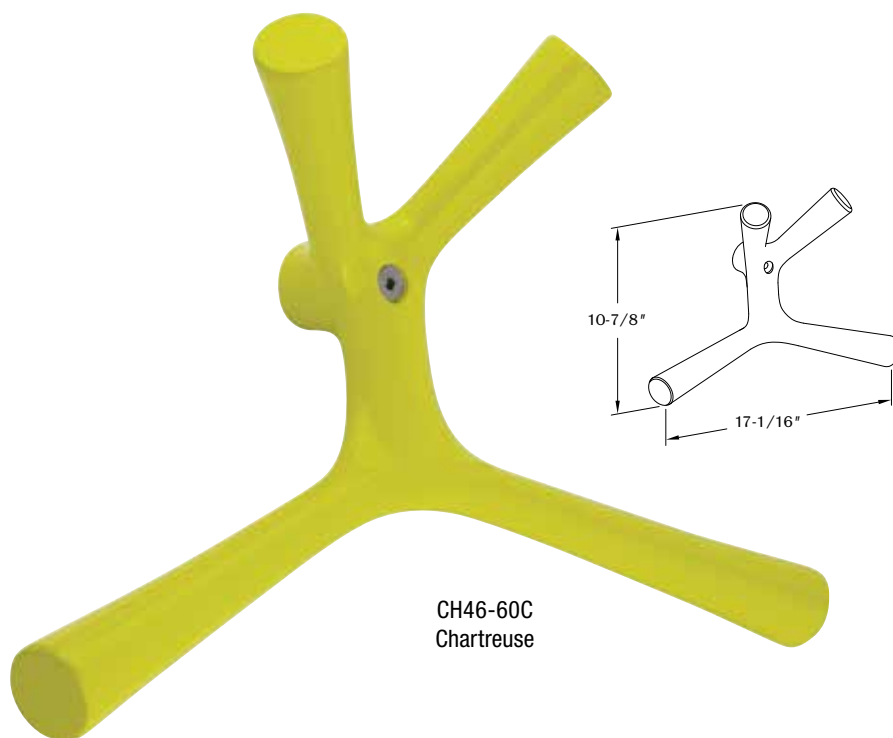

CH46-60C
Chartreuse

CH46

"KANGAROO" COAT HOOK

"Kangaroo" we call it. This exuberant and eye-catching sculpture is actually a coat hook! The two lower arms act as one hanger; simply drape a coat around both arms while the upper arms hold hats or additional coats. Cast of aluminum in five brilliant finishes.



53
Orange



60C
Chartreuse



90
Black



95
White



100
Polished Aluminum

HK24

HIDEAWAY MULTI-COAT HOOK

Dashingly subtle. Beautiful design, thoughtful execution. Press the bottom and out drops a stylish hook that can easily hold a single garment or up to five hangers. Then fold up the hook and tuck it away in the recessed housing where the hook completely hides away flush into the wall.



26

Polished Chrome



26D

Satin Chrome



SSS

Satin Stainless Steel



HK24-26
Polished Chrome

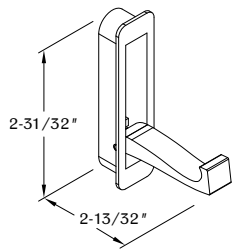
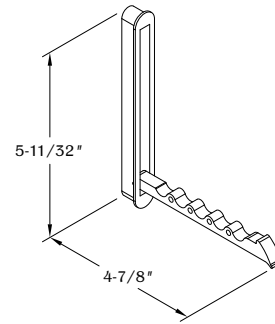

HK25-SSS
Satin Stainless Steel

HK25

HIDEAWAY COAT HOOK

A functional hook when you need it, hidden away when you don't. Press the bottom and out drops the stylish hook, then fold back up to hide away flush into the wall. Recessed into your wall or closet furniture. Sleek finish and unobtrusive design with stylish contours on the hook.



26

Polished Chrome



26D

Satin Chrome



SSS

Satin Stainless Steel

CH53

SQUARE PLATE COAT HOOK

Multi-Level Coat Hook design with a bold, gently curved face for coats and additional hook below for hats and scarves. Square plate has a gentle concaved bend to soften the hard lines and cast a unique light.



17S
Satin
Nickel



23
Metallic
Silver



26
Polished
Chrome



26D
Satin
Chrome



CH53-26
Polished Chrome

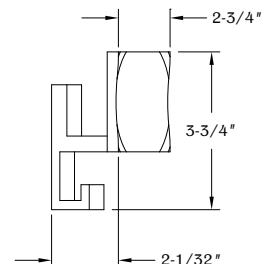

*Hooks for the extrovert or the introvert –
stand out in a crowd or hide away out of
sight when not in use.*



CH11-26D
Satin Chrome

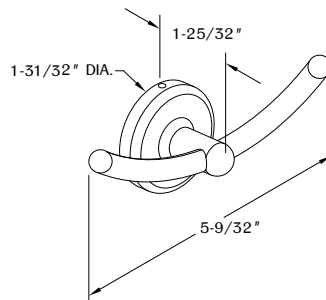

CH11

LONGHORN COAT HOOK

Mount Horns Up or Horns Down depending on your hanging needs. Horns down for a jacket, horns up for multiple clothes hangers. Beautiful striking appearance and polished finish.



26
Polished Chrome



26D
Satin Chrome

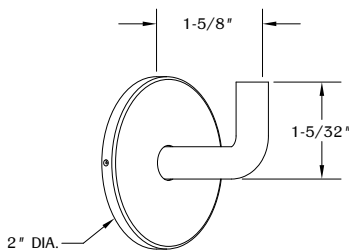

HK1-SSS
Satin Stainless Steel

HK1

SINGLE COAT HOOK

Stainless Steel Hook with matching cover plate is perfect for hanging a coat or a clothes hanger in your bath or closet area and fits right in with other stainless steel fixtures.



SSS
Satin Stainless Steel



CH1-23
Metallic Silver

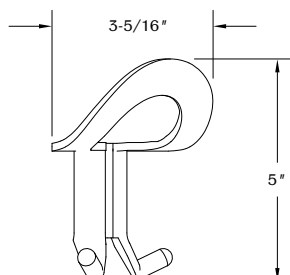

CH1

HOOK & LOOP COAT HOOK

Such an interesting shape! A big loop at the top, two smaller hooks at the bottom. Multi-hook version also available with three CH1 hooks mounted on a back plate, CH1K.



17S
Satin Nickel



23
Metallic Silver



90
Matte Black



95
Glossy White



Poodle stylists

By permission of Leigh Rubin and Creators Syndicate, Inc.

CH55

MARINA COAT HOOK

Floating sphere extends out from the round back plate with ample space for hanging coats or jackets with additional hook below for other garments. Meticulous contours make this artistic display a beautiful accent piece when not in use too!



26
Polished Chrome



CH55-26
Polished Chrome

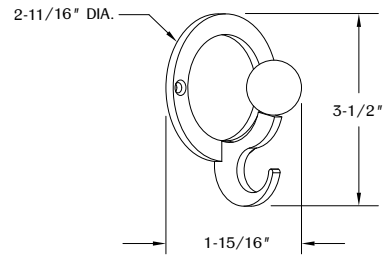

*Our signature designs
have multi-level hooks
for added hangers.*

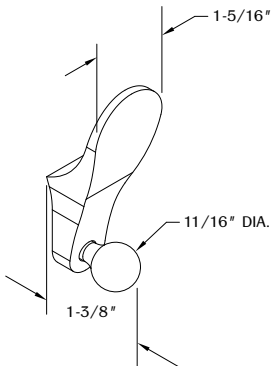

CH17-94
Satin Aluminum

CH17

BALL & TONGUE COAT HOOK

Aluminum Hook with sloping flat tongue plate and interesting ball hook below for hangers and hats. Combining interesting elements for a unique display and added functionality. Concealed fastener for a sleek look and flush mount.



94
Satin Aluminum

CH13

ORGANIC COAT HOOK

Interesting organic shape with fluid lines all add up to one distinctive coat hook! Hook slides over mounting bracket and is secured with allen screw. Hang a jacket up top and additional garments below.



17S
Satin Nickel



23
Metallic Silver
Polished Chrome



26





90

Matte Black

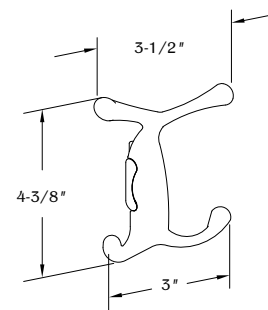

CH13-17S
Satin Nickel



A close-up photograph of a dark wood table edge. A metal hook is attached to the underside of the table, holding a brown leather strap and a white paper bag. The leather strap has white stitching and a metal buckle. The paper bag is simple and rectangular. The background is blurred, showing green foliage and a light-colored wall.

Keep your purse or hand bag within reach and out of harm's way.

PURSE HOOKS

*Your expensive handbag shouldn't have to be at risk while you dine or relax.
Protect your bag from spills and from potential theft.
Comfort and peace of mind are priceless.*

HK20

PURSE HOOK

Suspend a purse or bag under a bar top or table with a permanent under-table fixture that provides guests and patrons a convenient personal storage solution without having to fumble with their own flimsy portable purse hook clamp accessory. Groovy wave design ensures the hook will secure bags in place deep in the pocket and rounded front edge and soft contours won't snag or pinch fingers or straps. Aesthetically pleasing and inviting with thoughtful composition.



90
Matte Black



95
Glossy White



PSS
Polished Stainless Steel



SSS
Satin Stainless Steel



HK20-90
Matte Black

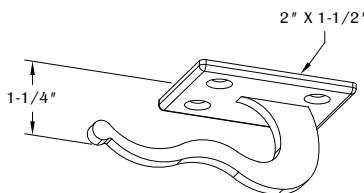

HK20V-SSS
Satin Stainless Steel



HK20/BB-PSS
Polished Stainless Steel



HK29-PSS
Polished Stainless Steel

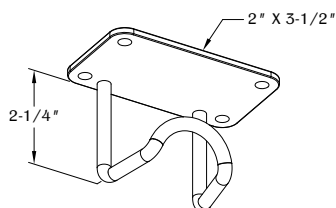

HK29

HITCH PURSE HOOK

Versatile utility hook has a very minimalist design with a focus on functionality and an industrial style that will go with any contemporary furniture. Dual steel pipes emerge from a solid back plate with fast form through an inverted raceway to secure bags, purses, or other items under a desk, or use on a wall in closets and mudrooms as a coat hook or in garages as a utility hook. Heavy duty construction for heavy duty usage.



PSS
Polished Stainless Steel

Don't ruin your beautiful backsplash with a wall plate. Add power to your countertop for access when you need it, then hide away when you don't.



Your Choice of Two Mounting Options

Surface Mount
Beveled Edge Sits
Above Surface



PCS103A/EE-26
Polished Chrome

OR

Flush Mount
Countersink To Sit
Flush with Surface



PCS103B/EE-90
Black

KITCHEN POWER

These kitchen power grommets are water resistant and can be mounted anywhere convenient power access is needed, whether at home or at the office in counter tops, kitchen islands, break rooms, and more. UL listed for wet areas and kitchen use.

Dual-Sided
Two Outlets per Unit



PCS103B/EE-17S
Satin Nickel

PCS103

SURFACE MOUNT 2 POWER POP UP

The perfect low profile addition to your kitchen counter top! Power within reach that pops up when you need it and presses down into the surface when you don't for a clean and stylish look.

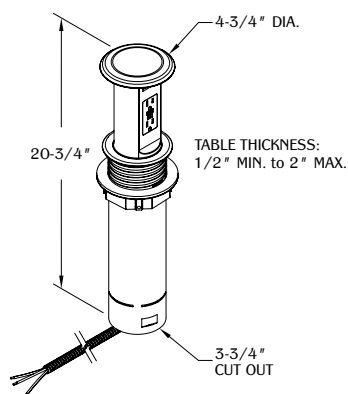
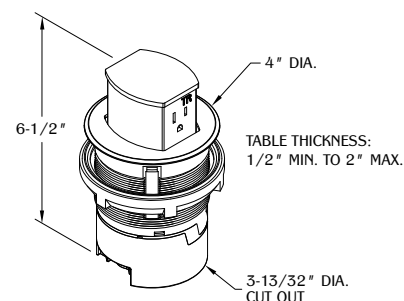
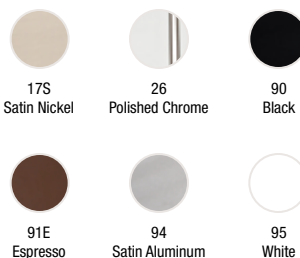

PCS77A-23
Glossy Metallic Silver

PCS77A

POP-UP KITCHEN POWER® GROMMET

Add convenient power access where you need it on the counter top or in kitchen islands with a water tight pop-up power solution. GFCI protected and includes Tamper Resistant receptacles, making it safe for the whole family. Press down on the top to pop up and access power, then press down to hide away nearly flush when not in use. Water tight seal prevents liquids from getting inside the unit and meets both UL and NEC requirements. Comes with 6' hardwire whip with 12 gauge 3 conductor wire.

KITCHEN & BATH

We entertain in kitchens, pamper ourselves in the bath, and store our precious possessions in closets. These are important spaces, so why not treat them as such? We offer only the best in Kitchen & Bath Hardware.

PTH4

PAPER TOWEL DISPENSER

Dispense paper towels in style. This industrial stainless steel dispenser gets the jobs done and looks great too!

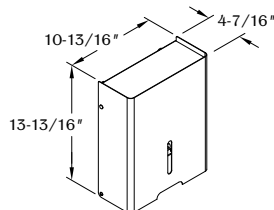

PTH4-SSS
Satin Stainless Steel

SL

UNDER SINK LINER

When is the last time you looked under your sink? I mean, really looked at it? Scary. Protect your cabinetry from spills, leaks, and other damage with a polished aluminum liner with rubber trim custom sized for your sink cabinet. Ships in 7-10 business days.



SL-94
Aluminum

SPD2/M

WALL MOUNTED SOAP DISPENSER

Flush stainless steel wall mount holds pump securely and holds 8 fluid ounces of soap. Clean, sterile design and contemporary, industrial look is perfect for your luxury restroom.

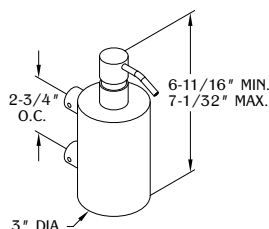

SPD2/M-SSS
Satin Stainless Steel

RCK6

ELEGANT TOWEL BAR

Stainless Steel towel bar with an elegant, thin cross bar. Comes with 2" diameter decorative cover plates to conceal mounting hardware. Characterized by its dainty appearance, noted for its tenacious execution.

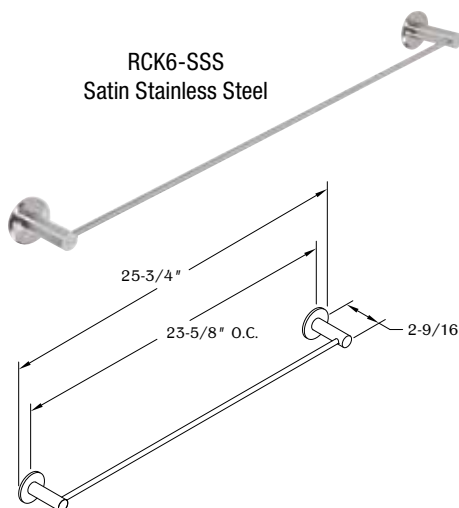

RCK6-SSS
Satin Stainless Steel

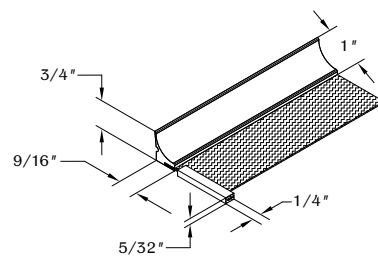

SPECIALTY GROMMETS

Curling iron holders and hair dryer holders will keep your personal bath space clutter-free. Great for beauty salons too!

CT1 & CT2

CURLING IRON HOLDER

Elegant curling iron holder made from a thick steel tube that absorbs heat well. Available in 1 1/2" diameter, CT1, or 2 1/2" diameter, CT2. Perfect for salons and private restroom vanities.

	(A) Length	(B) Cut Out	(C) DIA.
CT1	4 13/16"	1 1/2"	1 7/8"
CT2	4 27/32"	2 1/2"	3"



26
Polished Chrome



90
Matte Black

CT3

SCISSORS HOLDER

Hold scissors, combs, and other items in this grommet enclosure with steel bottom, padded with rubber. Perfect for salons and private vanity stations.

	(A) Length	(B) Cut Out	(C) DIA.
CT3	4 29/32"	2 1/2"	3"



26
Polished Chrome



90
Matte Black

HD1

HAIR DRYER HOLDER

Tapered design securely grips hair dryer and holds it in place. Special rubber and plastic composite that "gives" when hair dryer is inserted, and top rim is fashionably textured for a well-groomed appearance.



90
Matte Black



CT1-26
Polished Chrome



CT2-90
Matte Black

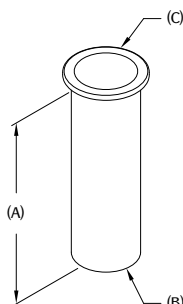

CT3-26
Polished Chrome



HD1-90
Matte Black

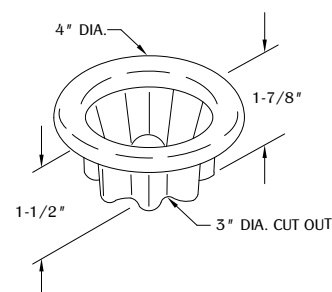

Trash Management Grommets protect your furniture from messy spills and stains.



ROUND TM	(A) HOLE SIZE	(B) DEPTH
TM4	4" DIA.	1"
TM1	6" DIA.	1"
TM1B	6" DIA.	2"
TM1C	6" DIA.	3"
TM1A	6" DIA.	6"
TM2	8" DIA.	1"
TM2B	8" DIA.	2"
TM2C	8" DIA.	3"
TM10	10" DIA.	1"
TM10B	10" DIA.	3"
TM12	12" DIA.	1"
TM12B	12" DIA.	3"

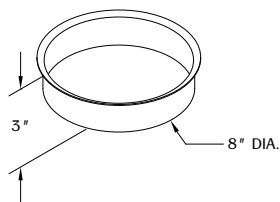

SQUARE TM	(A) HOLE SIZE	(B) DEPTH
TM1/SQ	6" SQ.	1"
TM1C/SQ	6" SQ.	3"
TM1A/SQ	6" SQ.	6"
TM2/SQ	8" SQ.	1"
TM2C/SQ	8" SQ.	3"
TM2A/SQ	8" SQ.	6"

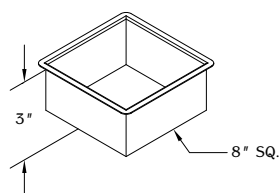

TRASH MANAGEMENT GROMMET LINERS

Line trash drops in restrooms, coffee shops, break rooms, movie theaters, food courts, doctor's offices, anywhere trash receptacles are needed. Or use in your own food prep areas for easy disposal of foodstuffs. Easy to remove and clean.



TM Series

TRASH MANAGEMENT GROMMETS

Trash Management Grommet Liners protect your furniture from messy spills by lining your trash bin drops. Perfect for commercial use in restrooms and food service establishments, and also great for food prep areas in kitchens and disposal bins in doctors' offices. Easy to remove and clean. Polished or Satin Stainless Steel in round or square in 20 sizes!



PSS
Polished Stainless Steel



SSS
Satin Stainless Steel

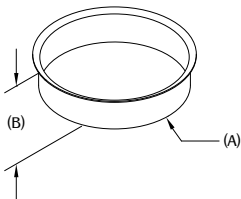

TM2C-PSS
Polished Stainless Steel



TM2C/SQ-SSS
Satin Stainless Steel

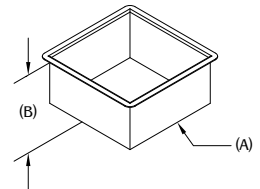

NON SEQUITUR © 2012 Wiley Ink, Inc.. Dist. By ANDREWS MCMEEL SYNDICATION. Reprinted with permission. All rights reserved.



Heavy Duty Shelf Brackets can be used for work surfaces, under counter supports, and more.

SWS2

INTER-ARC WORK SUPPORT

A simple arc design defines this support, lending strength as well as design integrity. Heavy duty brackets for shelves, wall-mounted work desks, or under-counter supports. Universal design is ideal for all styles of furniture from traditional to contemporary. Weight capacity: 400 lbs per pair



23
Metallic Silver



90
Matte Black



SWS2-23
Metallic Silver

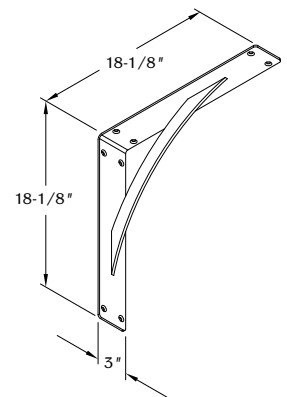

WORK SURFACE SUPPORTS

Just because your work surface is being mounted against a wall doesn't mean your brackets have to be so dull and bare. After all, they're still visible. We're pleased to bring some style to those mundane unsightly supports.

SWS3

CURVED ROD WORK SUPPORT

Discordant elements of curved rod joining square L-bracket harmonize to create one very good looking support structure. Suitable for any style, but best applicable on traditional furniture. Elements can even be custom finished separately for a very elegant end result. Weight capacity: 95 lbs each



23
Metallic Silver



90
Matte Black



SWS3-90
Matte Black

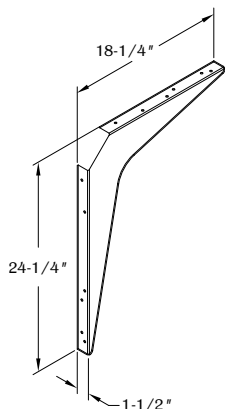
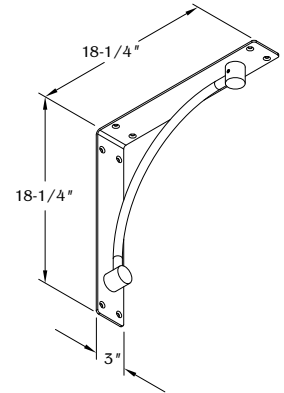

SWS4-92
Grey

SWS4

BASIC WORK SURFACE SUPPORT

Simple, stamped metal design is ideal for basic designs with heavy duty workloads. Cost-effective pricing for powder coat finishes, or available in Satin Stainless Steel for a more elegant look. Versatile mounting for shorter or deeper shelving – can be flipped and installed either way.

Weight capacity: 400 lbs per pair



90
Matte Black



92
Grey



95
White



SSS
Satin Stainless Steel

Shelf Supports are a critical element of your interior. Presentation is important and so are the details.



SHELF SUPPORTS

Why are the majority of shelf brackets so boring and downright tacky? Those gray angle irons may be ok for the garage, but they certainly won't cut it for the inside of your home or office. We offer stylish, quality alternatives. Take a look!

SH48A

SMALL ELEGANT SHELF SUPPORT

Give your shelving a contemporary look with these beautifully crafted shelf supports. Hollowed center channel inside its long thin frame gives a decorative touch. Hard lines merged with soft corners make this smooth modern design a universal accent piece on any shelf type. Also available in larger $9\frac{1}{32}$ " projection, SH48B. Weight capacity: 15 lbs each



SH48A-17S
Satin Nickel

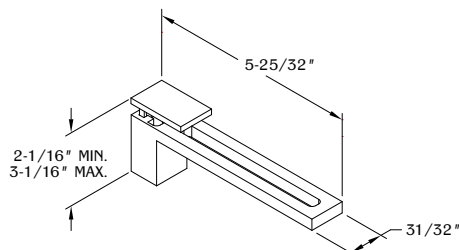

SH49A

SMALL WEDGE SHELF SUPPORT

Emerging from the wall like the bow of a ship, then slowly ascending up to the underside of the shelf surface, this wedge style support has an understated presence and effectively complements any shelf type. Also available in larger size with $6\frac{5}{16}$ " projection, SH49B. Weight capacity: 30 lbs each

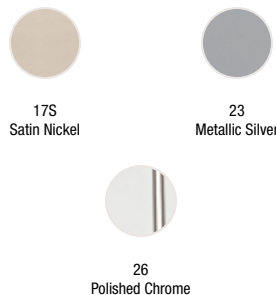

SH49A-23
Metallic Silver

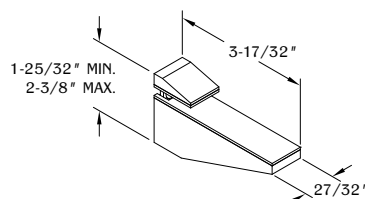

SH37

SHELF BRACKET

Two L-shaped brackets join together to create an adjustable shelf support. Expands to hold shelves from $\frac{3}{16}$ " to $1\frac{7}{8}$ " thick. Maximum shelf depth is 8". Versatile low profile brackets ease into any interior with a small footprint and subtle complementary nature. Four beautiful finishes to suit your application. Weight capacity: 7 lbs each

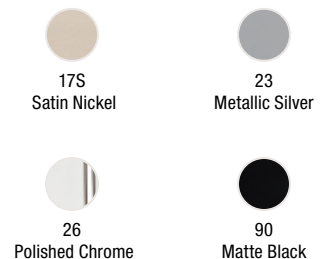

SH37-26
Polished Chrome

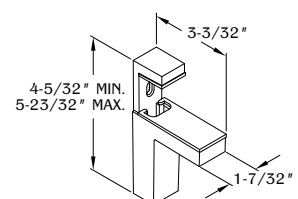

Shelf Track Systems are easy to install and easy to modify to fit your custom shelving needs.

SHELF TRACK

TRACK & BRACKET SET

Shelf Track Systems are the perfect way to display! Add additional tracks and brackets as needed to build out your custom arrangement. Brackets slide up and down the track to your exact desired location, then clamp down and lock into place. Easily configurable to any setup and can be moved and rearranged in seconds. Great for home entertainment displays, retail setups, and other showcase applications.



94
Satin Aluminum

Select Your Track: 3' or 6' lengths



C-Style

Select Your Brackets



SH14



SH15



SH16

Add An Optional Shelf

Sold in sets, or order individual components as needed for your custom application.

PART NUMBER	SH15A	SH15B	SH15C	SH15D	SH15E
BRACKET LENGTH	7-11/16"	9-11/16"	11-11/16"	15-11/16"	22-1/2"

SH17

BARREL-SHAPED SHELF SUPPORT

Machined from solid steel and finished. Elegance through simplicity. Versatile minimalist design is as functional as it is attractive with multi-purpose applications, also doubling as a vertical panel divider post. Weight capacity: 5 lbs each. Sold in sets of two.



SSS
Satin Stainless Steel

	(A) Projection	(B) Diameter
SH17	1 3/4"	1 3/8"
SH17A	1 1/32"	31/32"

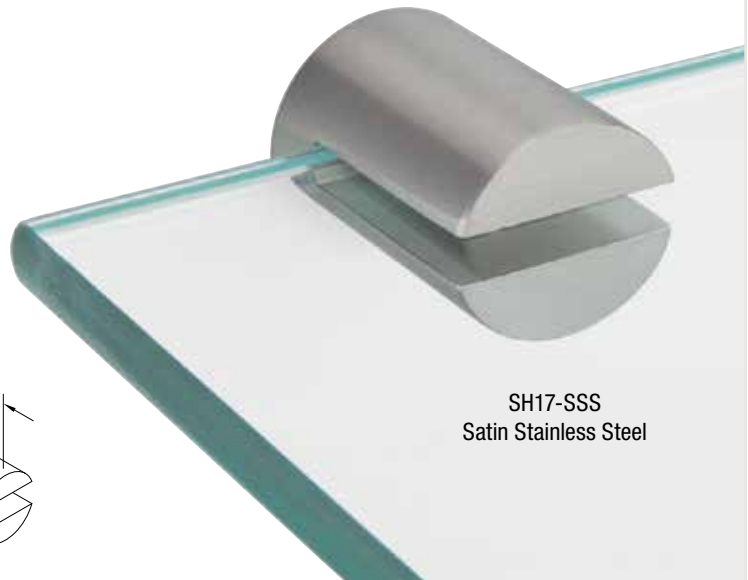
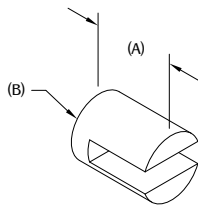

SH17-SSS
Satin Stainless Steel



SH18A-SSS
Satin Stainless Steel

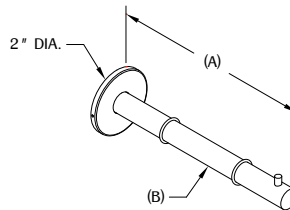

SH18B-SSS
Satin Stainless Steel

SH18

ROD & PIN SHELF BRACKETS

Stainless steel rod extends outward from mounting plate with cover. Has nifty retaining pin to hold shelf in place. Mounting screws included.



SSS
Satin Stainless Steel

	(A) Projection	(B) Diameter
SH18A	6 5/8"	3/16"
SH18B	8 13/16"	3/16"

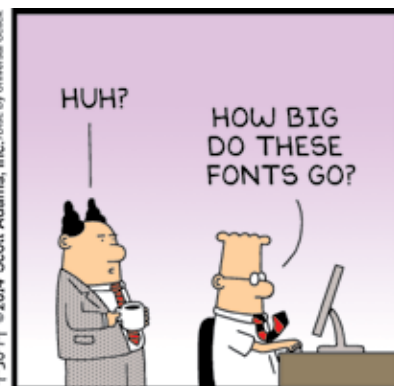

DILBERT © 2014 Scott Adams. Used By permission of ANDREWS MCMEEL SYNDICATION. All rights reserved.

POWER GROMMETS

Power Your Furniture with our Power Grommets! Easy to install, plug and play operation. Put power within reach on the surface level for easy charging access. Our power units pop up, flip up, install flush with your surface, or mount to the edge or underside of your desktop – we have every style, configuration, and finish to suit your specific needs. You'll love the functionality these devices add to your home or office furniture!

See our 1,000-plus options at www.mockett.com



PCS36 Series
Pop-Up Power Grommet



PCS64
Illuminated Pop-Up
Power Dock



PCS62B/USB
Flush Power Grommet



PCS86B/USB
Clamp Mount Power Grommet



PCS100A
Recessed Power Grommet



WCS1
Wireless Charging Leather Pad

WIRE MANAGEMENT

We put power within reach on your desktop. Now what do you do with your cables?

We have a solution for that too! We have tons of grommets, wire stays, raceways, and widgets of all kinds to keep your cables tucked away and to keep your work station looking neat and tidy. A clean work station free from clutter will actually enhance efficiency and promote wellness and stress-free performance. Tidying up those pesky cables at home or at the office is easier than you think.

See our 1,000-plus options at www.mockett.com



L03
Oval Grommet



RG3
Rectangular Grommet

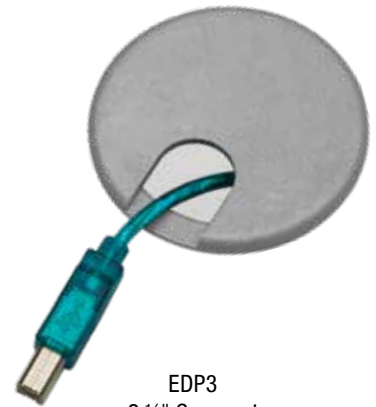

EDP3
2 1/2" Grommet



WM35
Spiral Wire Manager
w/Brush



MM3
1 3/4" Solid Brass
Grommet Cap/Liner



WM2A
J-Shape
Wire Manager

WM16
Snake Wire Manager



WORK SPACE ACCESSORIES

We have the tools to help you create an adaptable work space, customized to your specific needs. Optimize comfort, efficiency, and overall health and wellness with adjustable monitor arms, keyboard trays, storage trays, CPU holders, adjustable height table legs for sit stand desks, and more. All with your custom settings in mind to change the way you work. See our 100-plus options at www.mockett.com



PGRP1A
Panel Bracket



CPU1A
Universal CPU Holder



DWR5B
Large Circular Storage Drawer



FSA1
Single Vertical Flat Screen
Monitor Arm



KP6/M2
Keyboard Tray



WS1
Sit Stand Workstation Caddy



Follow Us



MOCKETT
DOUG MOCKETT & COMPANY, INC.

Doug Mockett & Company, Inc.

PO Box 3333 • Manhattan Beach • CA 90266

310.318.2491 • info@mockett.com • www.mockett.com