

PART #

FP2

PROPRIETARY AND CONFIDENTIAL.
ALL DIMENSIONS HAVE A +/- 1/32" TOLERANCE UNLESS OTHERWISE SPECIFIED. WE DO NOT RECOMMEND DRILLING OR CUTTING ANY HOLES BEFORE RECEIVING A PRODUCT OR A PRODUCT SAMPLE.

TABLE OF CONTENTS

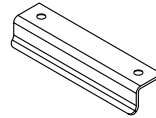

..... 1X FP2



..... 2X STDW050
(1/2" No. 6 Wood Screws)

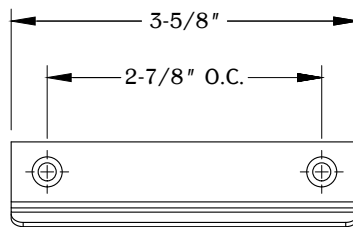
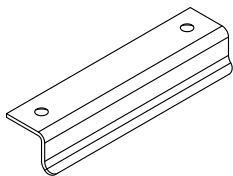

BOTTOM VIEW

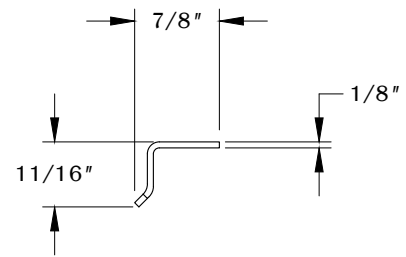

SIDE VIEW

1

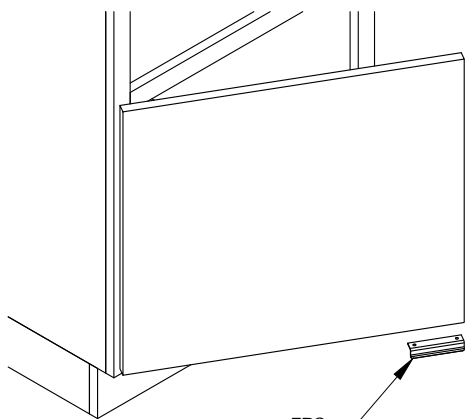

Determine the location of the part at the bottom of the cabinet door.

2

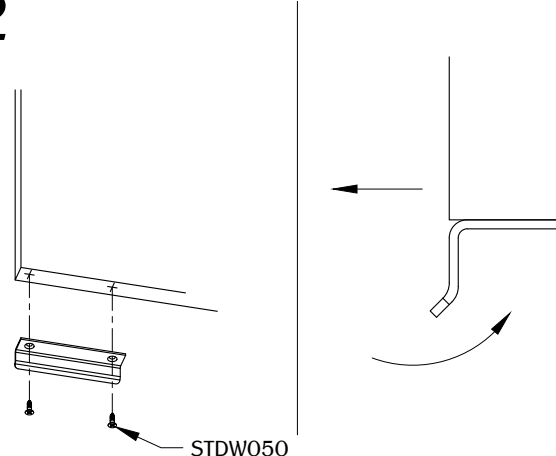

Install the part using the (2) STDW050 wood screws. (Note: Recommend removing the cabinet doors might be necessary for an accessible installation.)

PART #

FP2

PROPRIETARY AND CONFIDENTIAL.
ALL DIMENSIONS HAVE A +/- 1/32" TOLERANCE UNLESS OTHERWISE SPECIFIED. WE DO NOT RECOMMEND DRILLING OR CUTTING ANY HOLES BEFORE RECEIVING A PRODUCT OR A PRODUCT SAMPLE.

3

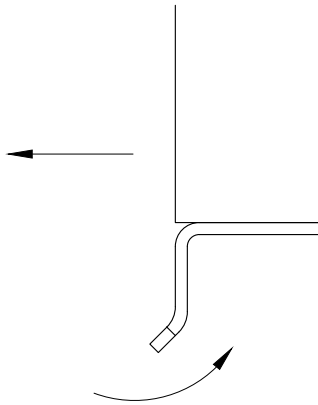

Use the box toe of the shoe to pull the cabinet door open.