

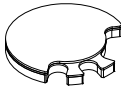
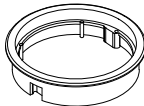

FG3B/M

PROPRIETARY AND CONFIDENTIAL.
ALL DIMENSIONS HAVE A +/- 1/16" TOLERANCE UNLESS OTHERWISE SPECIFIED. WE DO NOT RECOMMEND DRILLING OR CUTTING ANY HOLES BEFORE RECEIVING A PRODUCT OR A PRODUCT SAMPLE.

SPECIFICATIONS

- See Step 2 for floor thickness.

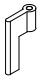
-  1X FG3B/M Lid
-  1X FG3B/M Liner
-  2X 2" No. 8 Mounting Screw
-  2X Wing Lock

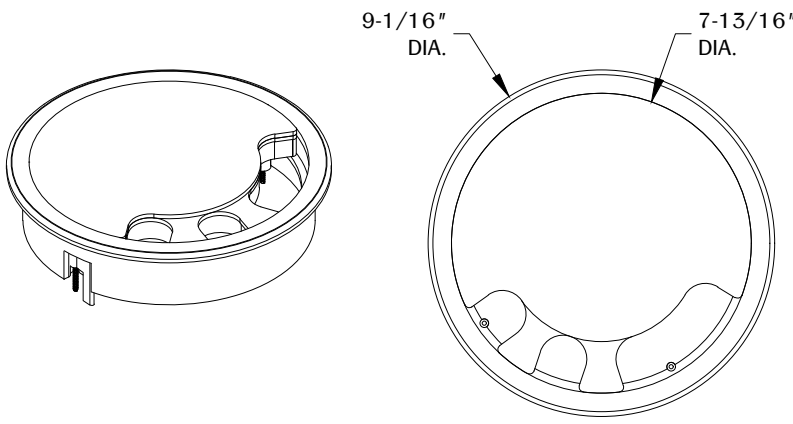

TOP VIEW

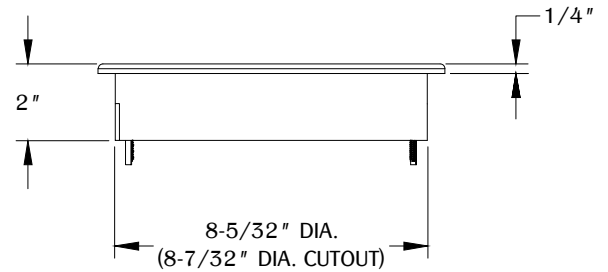

FRONT VIEW

1

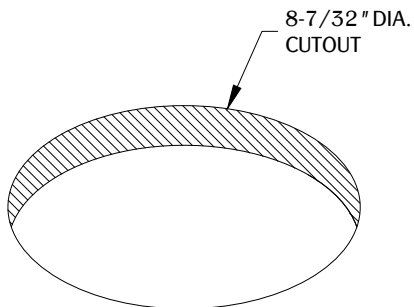

Cut an 8-7/32" diameter hole in the desired location on your work surface.

2

Top Orientation
1" MIN.
2" MAX. floor thickness.

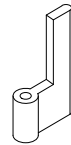

Bottom Orientation
1/2" MIN.
1-1/4" MAX. floor thickness.

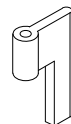

Determine the floor thickness and orientation of the wing lock.

FG3B/M

PROPRIETARY AND CONFIDENTIAL.
ALL DIMENSIONS HAVE A +/- 1/16" TOLERANCE UNLESS OTHERWISE SPECIFIED. WE DO NOT RECOMMEND DRILLING OR CUTTING ANY HOLES BEFORE RECEIVING A PRODUCT OR A PRODUCT SAMPLE.

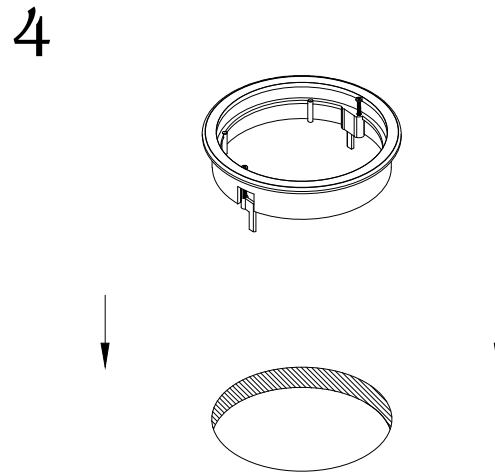
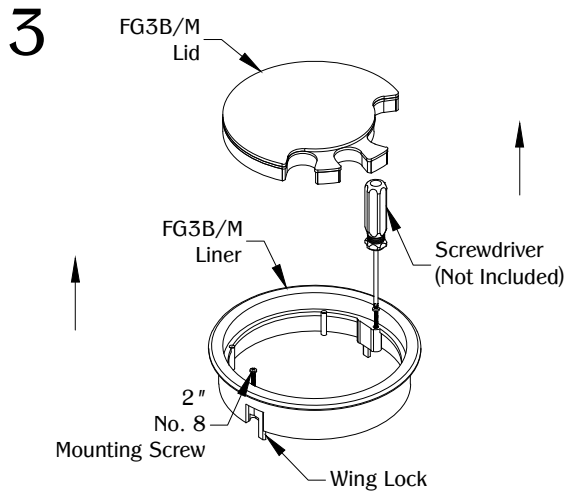

Install the FG3B/M liner into the cutout and make sure it is fully leveled on the work surface.

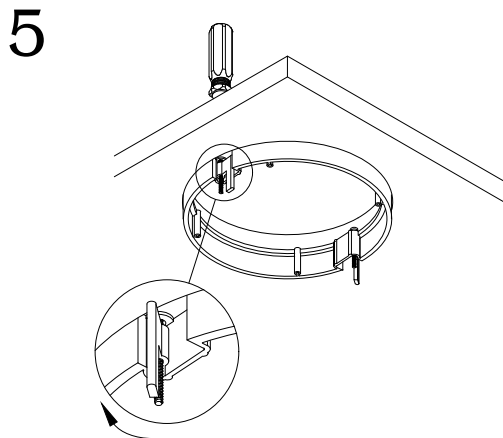

Secure part in place by rotating (2) wing lock clockwise then tighten (2) 2" No. 8 thread mounting screws into (2) wing lock.

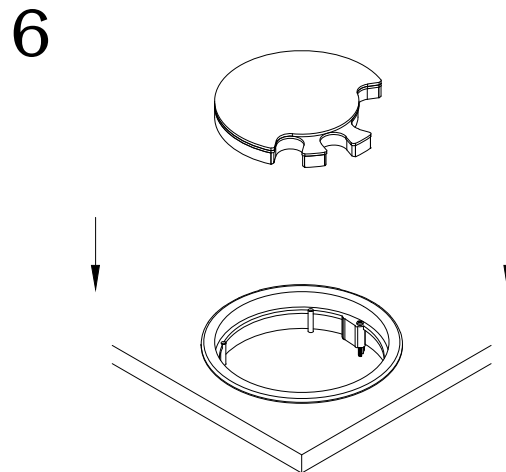

Insert FG3B/M lid into the FG3B/M liner.