

DP302

PROPRIETARY AND CONFIDENTIAL.
ALL DIMENSIONS HAVE A +/- 1/16" TOLERANCE UNLESS OTHERWISE SPECIFIED. WE DO NOT RECOMMEND DRILLING OR CUTTING ANY HOLES BEFORE RECEIVING A PRODUCT OR A PRODUCT SAMPLE.

SPECIFICATIONS

- Additional mounting screw lengths available upon request.

TABLE OF CONTENTS

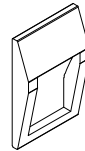

..... 1X DP302



..... 2X 1" M4 X 0.70 Thread Mounting Screw

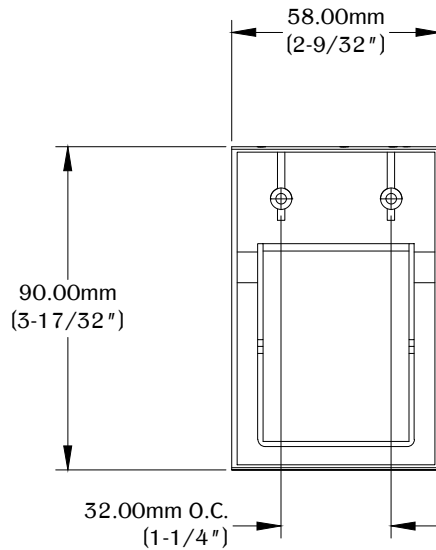
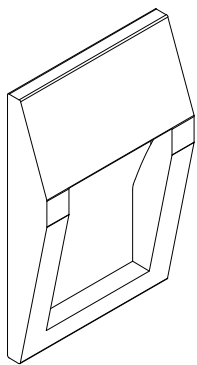

REAR VIEW

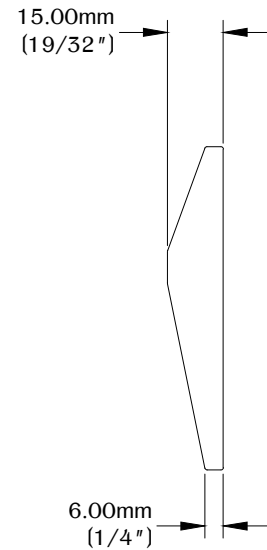

SIDE VIEW

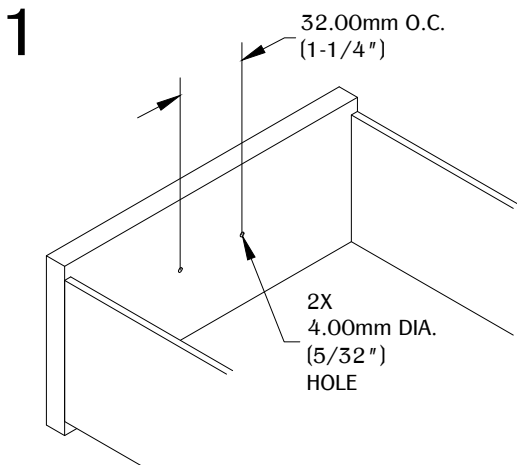

Determine the position and location of the part on the work surface. Mark the mounting positions and drill the hole for the mounting hardware.

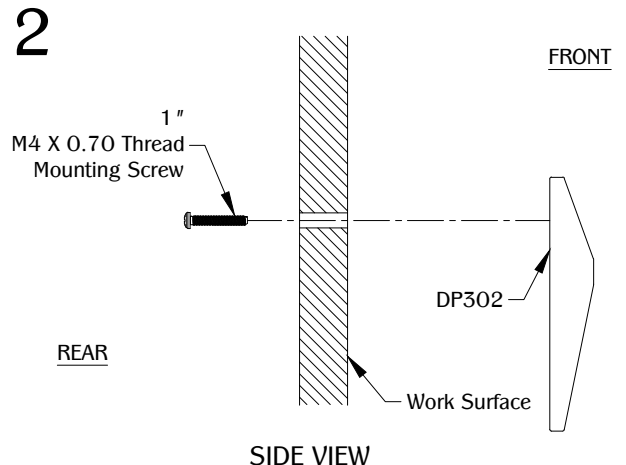

Use (2) 1" M4 X 0.70 thread mounting screw to secure the part to the work surface. Make sure the part is fully level on the work surface.