

BRV2

PROPRIETARY AND CONFIDENTIAL.
ALL DIMENSIONS HAVE A +/- 1/32" TOLERANCE UNLESS OTHERWISE SPECIFIED. WE DO NOT RECOMMEND DRILLING OR CUTTING ANY HOLES BEFORE RECEIVING A PRODUCT OR A PRODUCT SAMPLE.

SPECIFICATIONS

- Maximum cord diameter is 1-5/32".

TABLE OF CONTENTS

 1X BRV2 Lid
 1X BRV2 Liner

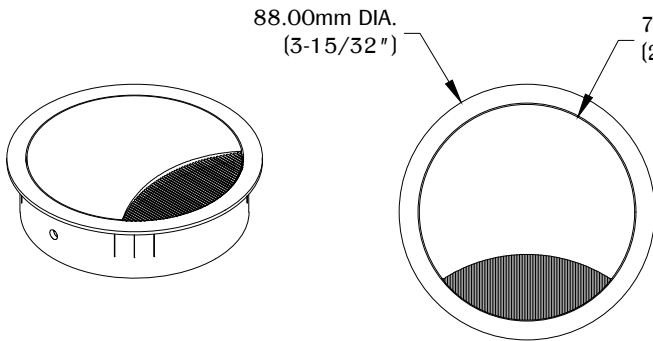

TOP VIEW

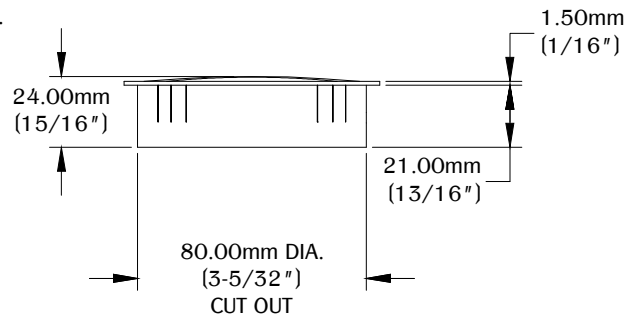

FRONT VIEW

1

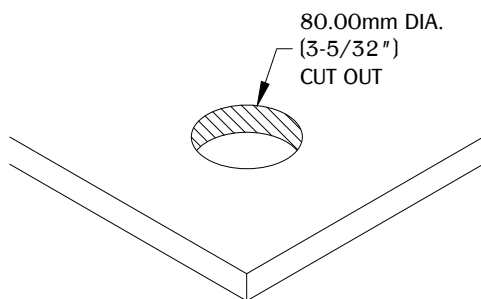

Make a cut out in the desired location on your work surface.
Cut a hole at 80.00mm(3-5/32") diameter.

2

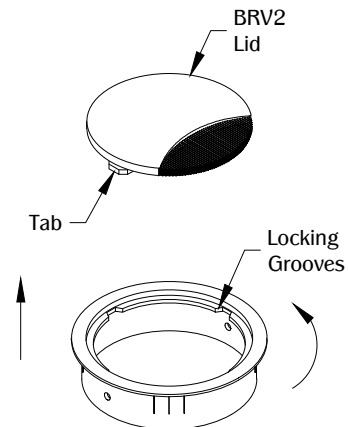

Remove BRV2 lid by rotating to match the tab to locking grooves and lifting from the brush opening.

BRV2

PROPRIETARY AND CONFIDENTIAL.
ALL DIMENSIONS HAVE A +/- 1/32" TOLERANCE UNLESS OTHERWISE SPECIFIED. WE DO NOT RECOMMEND DRILLING OR CUTTING ANY HOLES BEFORE RECEIVING A PRODUCT OR A PRODUCT SAMPLE.

3

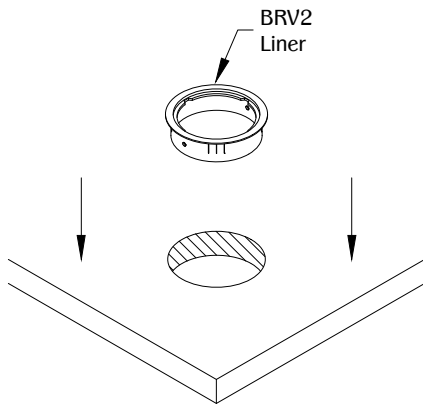

Install the BRV2 liner into the cut out and make sure it is fully leveled on the work surface.

4

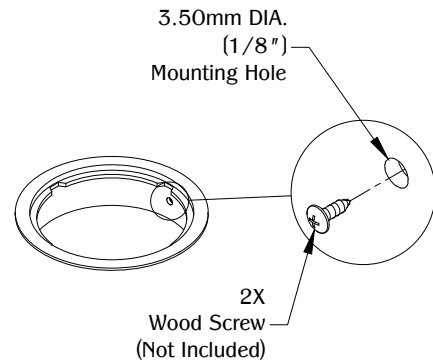

Use (2) wood screws to secure part onto the work surface. (Note: Use appropriate wood screw type and length depending on the material and thickness of the work surface.)

5

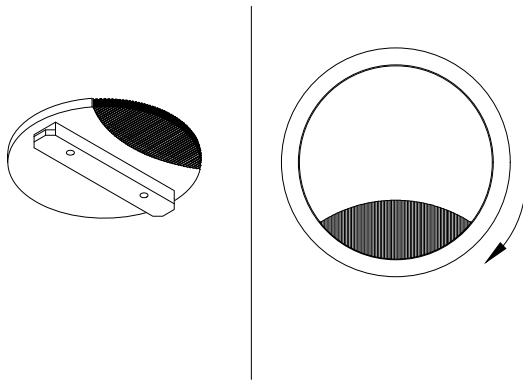

Install the BRV2 lid by aligning the tabs to locking groove and rotating BRV2 lid clockwise to lock.